



TM

AUTO METAL DIRECT

Our Name Says It All!™

**PLYMOUTH & DODGE
BODY PANELS**

\$5.00



B-Body



E-Body



A-Body

Come see our newly finished showroom, and

**SAVE BIG
ON SHIPPING**

**Pick up your
parts in person!!**



MOPAR, JEEP, DODGE, HEMI, PLYMOUTH, and CHRYSLER are trademarks of Chrysler LLC used under license to Auto Metal Direct, LLC. © Chrysler LLC 2008

2010

CHECK OUT THESE HOT NEW PARTS!

We have more Valance Panels than anyone!

Front & Rear Valance Panels



B-Body: Front, Pg. 6; Rear, Pg. 18
E-Body: Front, Pg. 24; Rear, Pg. 33
A-Body: Front, Pg. 38; Rear, Pg. 41

Four-Speed Shifter Tunnels



B-Body: Page 9
E-Body: Page 27
A-Body: Page 39

Hood Hinges



B-Body: Page 7
E-Body: Page 25

Rocker Panels



B-Body - Page 10
E-Body - Page 28
A-body - Page 39

Door Jamb Lock Pillars



B-Body: Page 13
E-Body: Page 31
A-Body: Page 41

Outer Wheel Houses



B-Body: Page 15
E-Body: Page 30
A-Body: Page 40

Rear Frame Rails



B-Body: Page 18
E-Body: Page 32
A-Body: Page 41

Trunk Floors



Most years available in both OE-style full floors or as halves.

B-Body: Page 14
E-Body: Page 30
A-Body: Page 40

Gas Tanks **NEW!**



Huge Selection!
B-Body: Pg. 17
E-Body: Pg. 32
A-Body: Pg. 41

Emblems



B-Body: Page 19
E-Body: Page 34

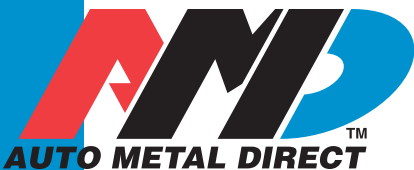

AUTO METAL DIRECT



Our Name Says It All!™

www.autometaldirect.com



Welcome to Auto Metal Direct () — your one stop source for the highest quality Chrysler body panels on the market.

Our staff has extensive experience in the collector car / restoration trade and will be happy to assist you. Check out our extensive inventory and let us help you get your car back in top condition!

 Auto Metal Direct, and our slogan ("Our Name Says it All[™]") are registered trademarks and cannot be duplicated or reproduced without written permission. All pictures and information contained in this catalog are property of .



MOPAR, DODGE, HEMI, PLYMOUTH, & CHRYSLER are registered trademarks of Chrysler LLC used under license to Auto Metal Direct, LLC. Chrysler LLC 2007 Logos and trademarks of various manufacturers are used under license by  and our suppliers. Any descriptions bearing trademarked names are for application reference only.



Hours

Monday – Friday

9:00 am – 6:00 pm EST

Toll Free Order Line

(866) 591-8309

Q&A Line

(770) 967-0909

Fax

(770) 692-6360

Email

sales@autometaldirect.com

Address

940 Sherwin Parkway, Suite 180,
Buford, GA 30518

Website

www.autometaldirect.com

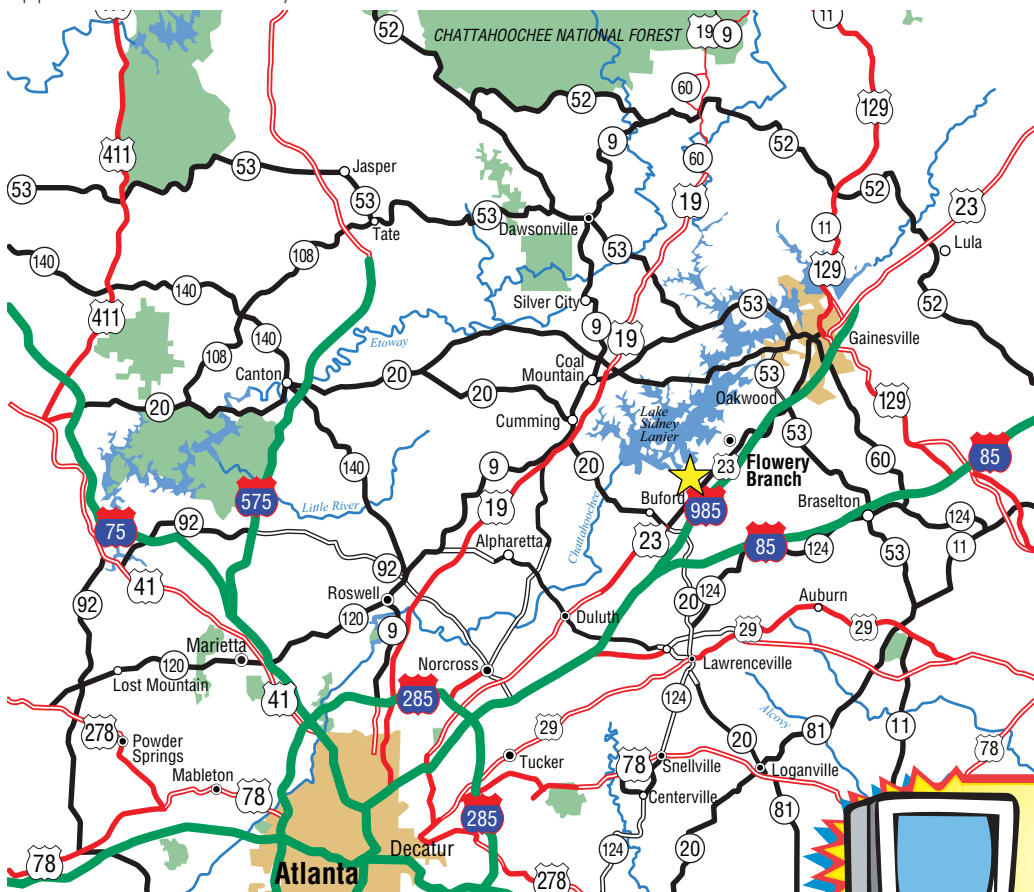

Directions

FROM ATLANTA:

Take I-85 North toward Greenville. Slight left to merge onto I-985 N/Gainesville/Lanier Parkway. Take Exit 8 for GA-347/Friendship Rd. toward Lake Lanier. Turn left at Friendship Rd/GA-347/Holiday Rd. Turn right at Atlanta Highway/GA-13 N/Gainesville Highway. Go 1/2 mile. Take Sherwin Parkway on Right.  is in the last building.



940 Sherwin Parkway, Suite 180
Buford, GA 30518

(866) 591-8309

"B" BODY

1962-74 "B" Body 2-Door

Some items listed below are not shown in the exploded view.

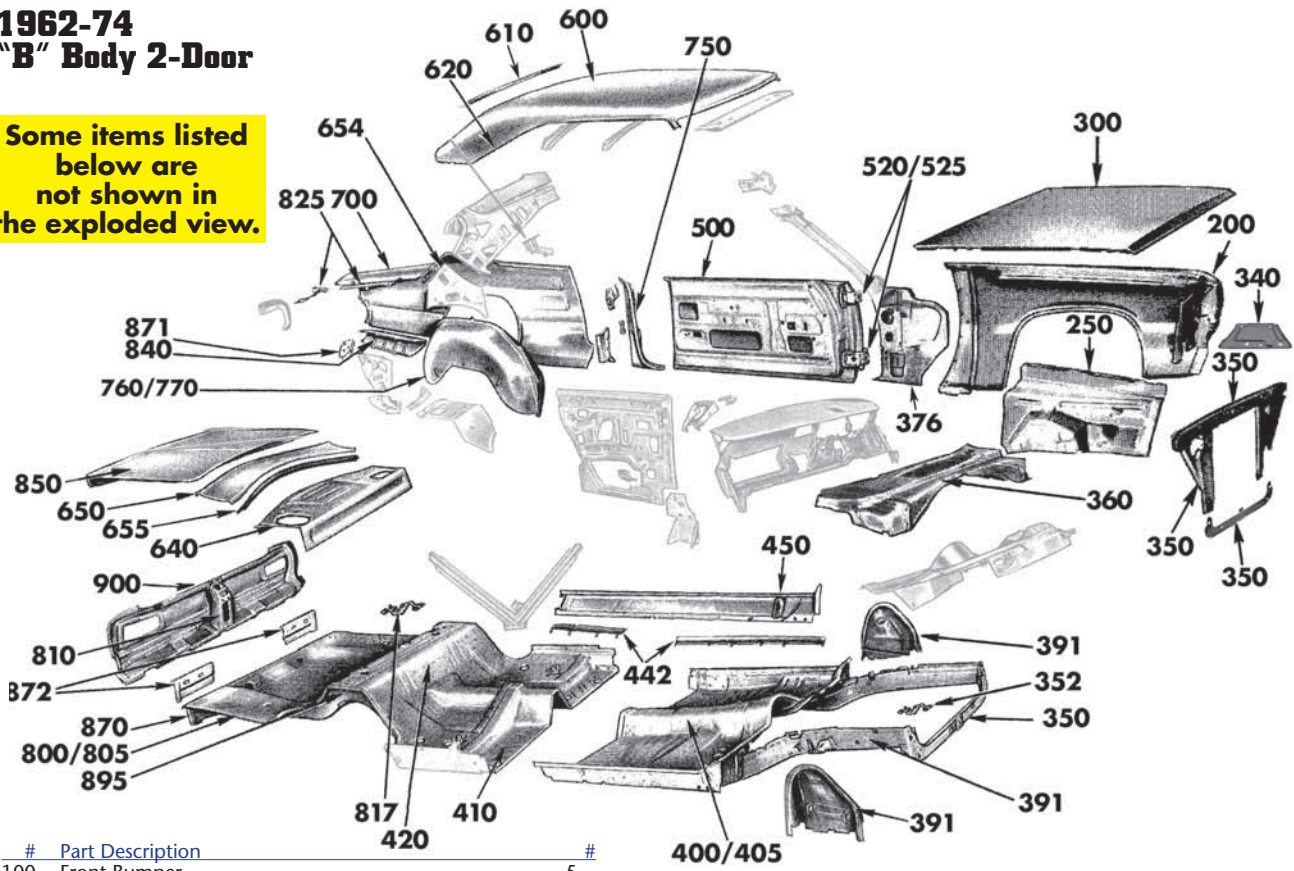

#	Part Description	#
100	Front Bumper	5
101	Bumper Bolt Set	5
105	Front Bumper Bracket Set	6
106	Front Stabilizer Bracket (Corner)	6
110	Front Bumper Guards & Bumperettes	6
120	Front Bumper Shield Lower	6
125	Front Valance	6
130	Lower Grille Panel	6
151	Upper Grille Reinforcement Fender Tie Bar	6
200	Front Fender	6
205	Fender Patch, Lower Rear	7
220	Front Fender Brace	7
250	Front Inner Fender	7
251	Fender Rear Splash Shield	7
255	Front Inner Fender Cover/Plate	7
260	Inner Fender to Cowl Bracket	7
300	Hood	7
310	Hood Hinges	7
320	Hood Insert Set	8
340	Battery Tray	8
350	Radiator Support	8
352	K Member to Radiator Support Brace	8
353	Inner Fender Splash Shield	8
360	Upper Cowl	8
376	Cowl Side Hinge Panel	8
380	Windshield	20
385	Windshield Molding Set	20
391	Front Frame Rail	8
395	Torsion Bar Crossmember	8
400	Front Floor Pan	8-9
405	Front Floor Pan Halves	9
410	Rear Floor Pan/Footwell Area	9
415	Four Speed Shifter Tunnel	9
420	Rear Floor Pan/Under Rear Seat	9
425	Main Floor Pan Support Set	9
440	Inner Rocker Panel	10
441	Emergency Cable Bracket	9
442	Floor Wiring Cover	9
450	Rocker Panels	10
451	Rocker Box / Rocker End Cap	10
490	Console Bracket Set	10
499	Complete Glass Kits	20
500	Door Shell	10
510	Door Skin	10
520	Door Hinge, Upper	10
525	Door Hinge, Lower	11
545	Window Regulator	11

#	Part Description	Page #
550	Door Glass	20
560	Vent Glass	20
562	Vent Window Support Bracket	11
600	Roof Skin	11
610	Roof Inner Structure	11
620	Drip Rail, Pair	11
639	Package Tray Brace	11
640	Package Tray	11
650	Deck Filler Panel	11
651	Deck Filler Panel Center Support	12
654	Deck Filler Patch	12
655	Lower Rear Window Frame	12
656	Deck Filler Panel Lower Plenum	12
660	Back Glass	21
670	Rear Windshield Molding Set	21
700	Quarter Panel, OE Style	12
710	Quarter Panel Skin	13
725	Quarter Panel Patch, Lower Front	13
750	Door Jamb Pillar	13
755	Quarter Panel Patch, Lower Rear	13
760	Inner Wheelhouse	14
761	Wheelhouse Vapor Canister Shield	14
770	Outer Wheelhouse	15
776	Quarter Panel Lower Rear Corner	15
795	Quarter Glass	20
796	Quarter Glass Latch Assembly	21
800	Trunk Floor	14
805	Trunk Floor Halves	14
810	Trunk Lock Support	15
816	Spare Tire Stud, Wing Nut, Hardware Set	15
817	Spare Tire Hold Down Bracket	16
818	Jack Bracket	16
820	Trunk Floor Brace	16
825	Trunk Gutter	16
840	Trunk Floor Extension	16
841	Trunk Floor Extension End Cap	17
850	Deck Lid	17
860	Upper Rear Crossmember (Shock Mount)	17
865	Rear Leaf Spring Mount	17
870	Rear Crossmember	17
871	Rear Crossmember Extension	17
872	Quarter Panel Inner Reinforcement	17
890	Gas Tanks	17
895	Rear Frame Rail	18
900	Taillight Panel	18
920	Taillight Panel Reinforcement Brackets	18
960	Rear Valance	18
962	Trunk Floor to Valance Reinforcement	18
970	Rear Bumper Bracket Set	18
990	Rear Bumper	19
999	Emblems	19

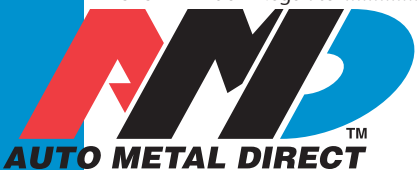

Our Name Says It All!™ www.autometaldirect.com

"B" BODY

The front-line soldiers for both Dodge and Plymouth during the muscle car wars were often B-Bodies. Back in the day, whenever you heard the unmistakable rumble of a big-block Mopar engine on the road, there was a very good chance it would be a Charger, Roadrunner, Super Bee, GTX, or Coronet RT.

Today muscle car enthusiasts worship these special cars (as you often see reflected in prices on the auction block!), but for many years it has been tough to find good quality body parts. Here at Auto Metal Direct we REALLY know Mopar cars inside and out. Check out the parts on the following pages!

Dodge
330/440
Charger
Coronet
Super Bee

Plymouth
Belvedere
GTX
Road Runner
Satellite

LH = Driver Side
RH = Passenger Side

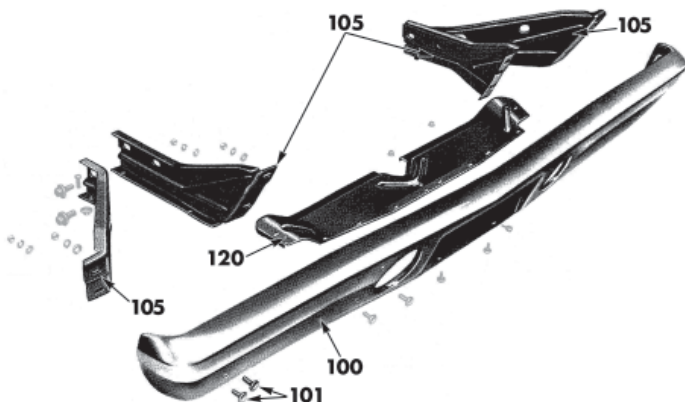

100) Front Bumper

Charger

YEAR	MODEL	PART #	PRICE
68-69	includes Bumperettes	100-2668	359.95

68-69	Front/Rear Set, includes Bumperettes	100-2668-S	689.95
-------	--------------------------------------	------------	--------

Dodge, except Charger

68-69		100-2468	399.95
-------	--	----------	--------

Plymouth

68-69		100-1468	399.95
1968	Front/Rear Set	100-1468-S	789.95
1969	Front/Rear Set	100-1469-S	789.95
1970		100-1470	399.95

101) Bumper Bolt Sets

(Bolt, Flat & Lock Washers, Nut)

16-piece set	101-1000-16S	9.95
24-piece set	101-1000-24S	12.95
32-piece set	101-1000-32S	14.95



Can't find your part in our catalog? Many new "B"-Body items are being developed! Call Us!

AMP
AUTO METAL DIRECT
Our Name Says It All!™

Authentic RESTORATION PRODUCT

MOPAR, JEEP, DODGE, HEMI, PLYMOUTH, and CHRYSLER are trademarks of Chrysler LLC used under license to Auto Metal Direct, LLC. © Chrysler LLC 2008

940 Sherwin Parkway, Suite 180
Buford, GA 30518

(866) 591-8309

105) Front Bumper Bracket Set



Charger

68-69	Front, 4 pieces	105-2668-S	149.95
68-69	Front/Rear/Center/ Outer set, 9 pieces (pictured above).....	105-2668-1S	329.95

Dodge, except Charger

68-69	Front set, 4 pieces.....	105-2468-S	149.95
68-69	Front/Rear set, 6 pieces.....	105-2468-1S	259.95

Plymouth

68-69	Front set, 4 pieces.....	105-1468-S	149.95
68-69	Front/Rear set, 6 pieces.....	105-1468-1S	259.95
1970	Front set, 4 pieces.....	105-1470-S	149.95
1970	Front/Rear set, 6 pieces.....	105-1470-1S	259.95

106) Front Stabilizer Bracket (Corner of Bumper)

68-69	Charger.....	106-2668-S	19.95
-------	--------------	------------	-------

110) Front Bumper Guards & Bumperettes

68-69	Charger (pair).....	110-2668-P	129.95
-------	------------------------	------------	--------

120) Front Bumper Shield, Lower (below bumper between bumper brackets)

68-69	Dodge, except Charger	120-2468	99.95
68-69	Plymouth	120-1468	99.95
1970	Plymouth	120-1470	99.95

125) Front Valance Charger

68-69	125-2668	229.95
1970	125-2670	299.95

125) Front Valance, continued Charger

YEAR	MODEL	PART #	PRICE
71-72	125-2671	249.95
73-74	125-2673	249.95

Plymouth

71-72	125-1471	349.95
-------	-------	----------	--------

130) Lower Grille Panel

68-69	Plymouth	130-1468	129.95
-------	----------------	----------	--------

151) Upper Grille Reinforcement Fender Tie Bar

68-69	Charger Grille/Headlight.....	151-2668	INQUIRE
-------	-------------------------------	----------	---------

200) Front Fender, OE Style



Charger

1968	LH.....	200-2668-L	699.95
1968	RH.....	200-2668-R	699.95
1969	LH (pictured).....	200-2669-L	699.95
1969	RH.....	200-2669-R	699.95



Plymouth

1968	LH.....	200-1468-L	699.95
1968	RH.....	200-1468-R	699.95
1969	LH (pictured).....	200-1469-L	699.95
1969	RH.....	200-1469-R	699.95

205) Fender Patch, Lower Rear (Includes brace)

68-70	LH.....	205-2668-L	129.95
68-70	RH.....	205-2668-R	129.95
71-74	LH.....	205-2671-L	129.95
71-74	RH.....	205-2671-R	129.95



**205) Fender Patch,
Lower Rear, continued**
(Includes brace)

Dodge, except Charger

68-70 LH.....	205-2468-L	129.95
68-70 RH.....	205-2468-R	129.95

Plymouth

68-69 LH.....	205-1468-L	129.95
68-69 RH.....	205-1468-R	129.95
71-72 LH.....	205-1471-L	129.95
71-72 RH.....	205-1471-R	129.95
73-74 LH.....	205-1473-L	129.95
73-74 RH.....	205-1473-R	129.95

220) Front Fender Brace

68-69 except Charger, Pair.....	220-1468-P	29.95
---------------------------------	------------	-------

250) Front Inner Fender, OE Style



66-70 LH.....	250-1466-L	209.95
66-70 RH.....	250-1466-R	209.95
66-70 Pair (pictured).....	250-1466-P	399.95



1971 LH.....	250-1570-L	209.95
1971 RH.....	250-1570-R	209.95
1971 Pair (pictured).....	250-1570-P	399.95
1972 LH.....	250-1572-L	209.95
1972 RH.....	250-1572-R	209.95
1972 Pair.....	250-1572-P	399.95

Fender patches for other years and models being developed. Please inquire.

251) Fender Rear Splash Shields

1963 Dodge & Plymouth, Pair.....	251-1463-P	179.95
1964 Dodge, Pair.....	251-2464-P	179.95
1964 Plymouth, Pair.....	251-1464-P	179.95
1965 Dodge & Plymouth, Pair.....	251-1465-P	179.95
66-67 Plymouth, Pair.....	251-1466-P	179.95
68-70 Dodge, Pair (pictured).....	251-2468-P	179.95
68-70 Plymouth, Pair.....	251-1468-P	179.95



255) Front Inner Fender Cover/Plate

62-65 Pair.....	255-1462-P	29.95
66-70 Pair (pictured).....	255-1466-P	19.95
71-72 Pair.....	255-1570-P	19.95



260) Inner Fender to Cowl Bracket

Use when replacing inner fender or cowl

Upper		
66-70 LH.....	260-1466-L	49.95
66-70 RH (pictured).....	260-1466-R	49.95
66-70 Pair.....	260-1466-P	89.95
Lower		
66-70 LH (pictured).....	260-1466-1L	49.95
66-70 RH (pictured).....	260-1466-1R	49.95



310) Hood Hinges

68-70 Pair, includes springs.....	310-1468-P	249.95
-----------------------------------	------------	--------

Replace the rusted, bent, or missing original Hood on your Charger, Roadrunner, GTX, or Satellite, with these beautiful brand-new top-quality reproduction Hoods from craftsmen who really know Dodge and Plymouth muscle car sheet metal.

HOODS

A brand new Steel Hood is the only way to go!

Eliminate the rust, dents, body-filler, and hood scoop holes found in old worn B-Body hoods with a brand new steel factory-style Hood from Auto Metal Direct. All underside bracing and brackets are faithful reproductions of originals, and are manufactured on our own steel tools. Fully coated with EDP, these gorgeous hoods will look great on your car for a very long time.

300) Hoods

Charger

68-69 (pictured, above).....	300-2668	699.95
------------------------------	----------	--------

Road Runner

1968 Road Runner/GTX, fits some 1968, INQUIRE for fitment.....	300-1468-A	699.95
68-69 Road Runner/GTX (pictured, center).....	300-1468	699.95
1970 Standard, with pin holes.....	300-1470-1H	699.95
1970 without pin holes.....	300-1470-1	699.95
1970 Fresh Air with pin holes (pictured, below).....	300-1470-2H	849.95
1970 Fresh Air without pin holes.....	300-1470-2	849.95

Fresh Air versions include air grabber door



Don't forget to see our new, lower prices on hood insert sets. See Section 320.



940 Sherwin Parkway, Suite 180
Buford, GA 30518

(866) 591-8309

320) Hood Insert Road Runner and GTX

NEW LOWER PRICES!

- 1969 Standard Version, (with die cast base, ribbed top, gaskets, and mounting nuts) (pictured at right) 320-1469-S 199.95
- 1970 without Lamp 320-1470-1 74.95
- 1970 with Lamp 320-1470-2 74.95

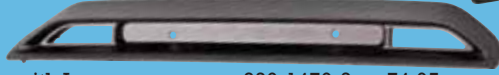

340) Battery Tray

(Correct reproductions of original style trays)



- 62-65 includes bracket 340-1462 39.95
- 66-69 includes brackets (pictured, left) 340-1466 29.95
- 70-72 (pictured, right) 340-1570 29.95
- 73-74 340-1473 29.95

C-Body (full size)

- 65-73 340-1665 39.95

350) Radiator Support

(Lower section is not welded to assembly for ease of installation.)



- 66-68 Assembly (pictured) 350-1466 349.95
- 69-70 Assembly 350-1469 349.95
- 71-72 Assembly 350-1570-S 349.95



- 66-70 Lower 351-1466 199.95



- 71-72 Lower 351-1570 199.95

352) K Member to Radiator Support Brace

- 66-70 352-1466 29.95



353) Inner Fender Splash Shield

(screws to valance panel and front fender)



- 68-69 Charger, Pair 353-2668-S 99.95

360) Upper Cowl



- 66-70 360-1466 399.95



- 66-70 Lower Cowl 360-1466-1 299.95

370) Firewall

- 66-70 with AC 370-1466-AC INQUIRE
- 66-70 without AC 370-1466 INQUIRE

376) Cowl Side Hinge Panel

- 66-70 LH 376-1466-1L INQUIRE
- 66-70 RH 376-1466-1R INQUIRE



380) Windshield - see Glass Section, page 20

385) Windshield Moulding Set - see page 20

391) Front Frame Rail, OE Style

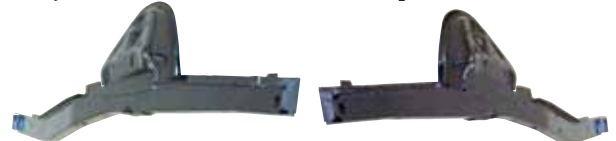

- 66-70 LH 391-1466-L 499.95
- 66-70 RH 391-1466-R 499.95

395) Torsion Bar Crossmember



- 66-70 395-1466 399.95

400) Front Floor Pan, OE Style

(Complete coverage like original)



- 62-65 Comes with fasteners and brackets for speedometer cable, emergency brake cable & seat belts 400-1462 599.95

400) Front Floor Pan, OE Style, continued

(Complete coverage like original)



YEAR	MODEL	PART #	PRICE
66-70	Comes with fasteners and brackets for speedometer cable, emergency brake cable & seat belts	400-1466	499.95



71-72	Comes with fastener for speedometer cable	400-1571	499.95
-------	---	----------	--------

405) Front Floor Pan Halves

(Does not include top area of transmission tunnel)



66-70	LH	405-1466-L	199.95
66-70	RH	405-1466-R	199.95
71-73	LH	405-1571-L	199.95
71-73	RH	405-1571-R	199.95

410) Rear Floor Pan/Footwell Area, OE Style

(Connects to Full Floor Pan to give complete OE style floor coverage.)



1962	& 1965 Dodge, LH	410-1462-L	149.95
1962	& 1965 Dodge, RH	410-1462-R	149.95
62-65	Plymouth, LH	410-1462-L	149.95
62-65	Plymouth, RH	410-1462-R	149.95
63-64	Dodge, LH	410-2463-L	149.95
63-64	Dodge, RH	410-2463-R	149.95

410) Rear Floor Pan/Footwell Area, OE Style, continued

(Connects to Full Floor Pan to give complete OE style floor coverage.)

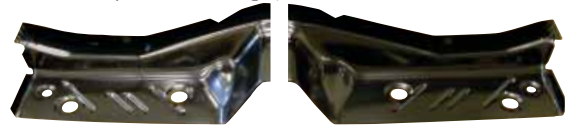

68-70	LH	410-1466-L	129.95
68-70	RH	410-1466-R	129.95
68-70	Pair (pictured)	410-1466-P	199.95



1971	LH (modify for 1972)	410-1471-L	129.95
1971	RH (modify for 1972)	410-1471-R	129.95
1971	Pair (modify for 1972)	410-1471-P	199.95

415) Four-Speed Shifter Tunnel



66-70	(with and without console)	415-1466	149.95
71-74	(no console)	415-1471	149.95
71-74	(with console)	415-1570	149.95

420) Rear Floor Pan/ Under Rear Seat



Includes brackets for emergency brake cable, exhaust hanger and pinion snubber welded in place.

68-70	Will fit 66-67 with slight modifications	420-1468	399.95
-------	--	----------	--------

425) Main Floor Pan Supports

Use when replacing floorpan



66-70	4-piece set	425-1466-S	129.95
-------	-------------	------------	--------

437) Rocker to Frame Lower Splash Shield

68-70	LH (2 pieces)	437-1468-L	INQUIRE
68-70	RH (2 pieces)	437-1468-R	INQUIRE

441) Emergency Cable Bracket

66-70		441-1466	19.95
-------	--	----------	-------



442) Floor Wiring Cover

Use when replacing floorpan



68-70	4-piece set	442-1466-S	99.95
-------	-------------	------------	-------



MOPAR, JEEP, DODGE, HEMI, PLYMOUTH, and CHRYSLER are trademarks of Chrysler LLC used under license to Auto Metal Direct, LLC. © Chrysler LLC 2008

940 Sherwin Parkway, Suite 180
Buford, GA 30518

(866) 591-8309

440) Inner Rocker Panel



YEAR	MODEL	PART #	PRICE
66-70	B-Body, LH.....	440-1466-L	199.95
66-70	B-Body, RH.....	440-1466-R	199.95

450) Rocker Panel (Outer skin or sill)



68-70	LH.....	450-1468-L	299.95
68-70	RH.....	450-1468-R	299.95

451) Rocker Box / Rocker End Cap

(Fits on front end of rocker panel)

68-70	LH.....	451-1468-L	17.95
68-70	RH.....	451-1468-R	17.95

460) Dash Accessories

71-74	Dash bezel stickers, set of 4 (chrome plated).....	460-1471-S	INQUIRE
-------	---	------------	---------

490) Console Bracket Set



68-70	Automatic Transmission, 3-piece set <i>(pictured, left)</i>	490-1466-AS	149.95
68-70	Manual Transmission, 3-piece set <i>(pictured, right)</i>	490-1466-MS	89.95

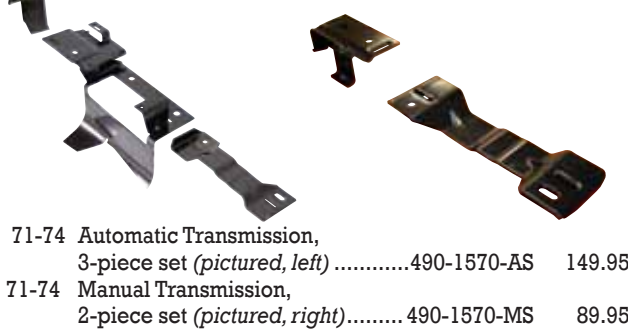

71-74	Automatic Transmission, 3-piece set <i>(pictured, left)</i>	490-1570-AS	149.95
71-74	Manual Transmission, 2-piece set <i>(pictured, right)</i>	490-1570-MS	89.95

499) Complete Glass Kits - see page 20



**Check our Website
for the
Latest Updates:
autometaldirect.com**

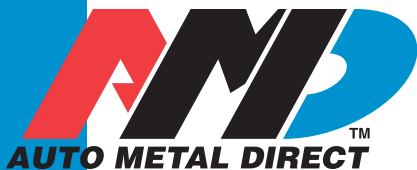

Our Name Says It All!™

www.autometaldirect.com

500) Door Shell, OE Style



**Dodge & Plymouth,
except Charger**

1968	2-Door & Convertible, LH <i>(pictured)</i>	500-1468-L	599.95
1968	2-Door & Convertible, RH	500-1468-R	599.95
69-70	2-Door & Convertible, LH.....	500-1469-L	599.95
69-70	2-Door & Convertible, RH	500-1469-R	599.95



Charger

1968	LH.....	500-2668-L	599.95
1968	RH.....	500-2668-R	599.95
69-70	LH <i>(pictured)</i>	500-2669-L	599.95
69-70	RH.....	500-2669-R	599.95

510) Door Skin

**Dodge & Plymouth,
except Charger**

68-70	LH.....	510-1468-L	299.95
68-70	RH.....	510-1468-R	299.95



Charger

68-70	LH.....	510-2668-L	299.95
68-70	RH.....	510-2668-R	299.95
71-72	LH.....	510-2671-L	299.95
71-72	RH.....	510-2671-R	299.95
1971	Charger RT, LH.....	510-2671-1L	299.95
1971	Charger RT, RH	510-2671-1R	299.95
1972	Charger Rallye, LH <i>(pictured)</i>	510-2672-L	299.95
1972	Charger Rallye, RH.....	510-2672-R	299.95

Plymouth

71-72	LH.....	510-1471-L	299.95
71-72	RH.....	510-1471-R	299.95

520) Door Hinge, Upper

YEAR	MODEL	PART #	PRICE
62-65	LH.....	520-1462-L	69.95
62-65	RH.....	520-1462-R	69.95
66-70	LH.....	520-1466-L	69.95
66-70	RH.....	520-1466-R	69.95
71-74	LH.....	520-1471-L	69.95
71-74	RH.....	520-1471-R	69.95



Upper / Lower Hinge Sets

62-65	Upper / Lower Set, 4 pieces.....	520-1462-S	229.95
66-70	Upper / Lower Set, 4 pieces.....	520-1466-S	229.95
71-74	Upper / Lower Set, 4 pieces.....	520-1471-S	229.95



525) Door Hinge, Lower

62-65	LH.....	525-1462-L	89.95
62-65	RH.....	525-1462-R	89.95
66-70	LH.....	525-1466-L	89.95
66-70	RH.....	525-1466-R	89.95
71-74	LH.....	525-1471-L	89.95
71-74	RH.....	525-1471-R	89.95



545) Window Regulator



66-70	except '66 Charger, LH.....	545-1466-L	119.95
66-70	except '66 Charger, RH.....	545-1466-R	119.95

550) Door Glass & 560) Vent Glass, see page 20

562) Vent Window Support Bracket

(Holds vent pane assembly to bottom of door)

62-65	B-Body, LH.....	562-1462-L	21.95
62-65	B-Body, RH.....	562-1462-R	21.95

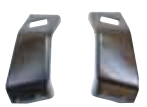

600) Roof Skin, OE Style



68-70	except Charger.....	600-1468	599.95
-------	---------------------	----------	--------



68-70	Charger.....	600-2668	599.95
-------	--------------	----------	--------

IN DEVELOPMENT:
Charger under roof structure including area around back window.

610) Roof Inner Structure

(Fits above back glass under roof skin)



68-70	Charger Rear Bow.....	610-2668-1	109.95
-------	-----------------------	------------	--------

620) Drip Rail, Pair

Use when replacing roof skin



68-70	including Charger.....	620-1468-S	199.95
-------	------------------------	------------	--------

640) Package Tray (Speaker Panel)

(Also see 655) Lower Rear Window Frame)



68-70	except Charger.....	640-1468	349.95
-------	---------------------	----------	--------

Charger



68-70	640-2668	349.95
-------	-------	----------	--------

68-70 Trim Retainer

(mounts on lower rear window frame).....

640-2668-1	59.95
------------	-------

650) Deck Filler Panel



68-70	except Charger.....	650-1468	169.95
-------	---------------------	----------	--------



68-70	Charger.....	650-2668	299.95
-------	--------------	----------	--------



71-74	Plymouth, will fit 71-74 Charger with minor modification.....	650-1471	199.95
-------	--	----------	--------



MOPAR, JEEP, DODGE, HEMI, PLYMOUTH, and CHRYSLER are trademarks of Chrysler LLC used under license to Auto Metal Direct, LLC. © Chrysler LLC 2008

940 Sherwin Parkway, Suite 180
Buford, GA 30518

(866) 591-8309

651) Deck Filler Panel Center Support

Use when replacing deck filler panel or package tray

68-70 except Charger
(2 required per car)
..... 651-1468 29.95



654) Deck Filler Patch - except Charger

(repairs rust in lower corners of back glass)



68-70 Outside piece, LH 654-1468-1L 89.95
 68-70 Outside piece, RH 654-1468-1R 89.95
 68-70 Inner / Lower, LH 654-1468-2L 29.95
 68-70 Inner / Lower, RH 654-1468-2R 29.95
 68-70 Inner and Outer, 4-piece set
(pictured) 654-1468-S 199.95

655) Lower Rear Window Frame

Use when replacing deck filler panel and/or package tray



68-70 except Charger 655-1468 139.95
 68-70 Charger (pictured) 655-2668 139.95

656) Deck Filler Panel Lower Plenum

Use when replacing deck filler panel

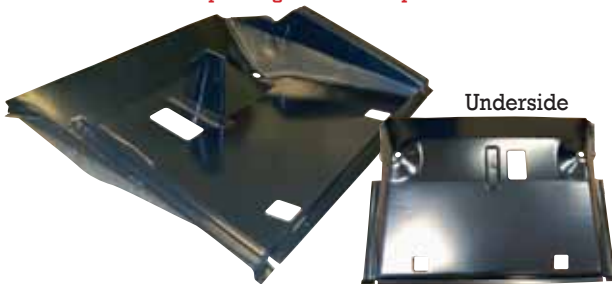

68-70 Charger 656-2668 249.95

660) Back Glass, see Glass Section, page 21

670) Rear Window Moulding Set - see Glass Section, page 21

700) Quarter Panel, OE Style

(Complete coverage like originals)

Charger



1968 LH (pictured) 700-2668-L 749.95
 1968 RH 700-2668-R 749.95
 1969 LH 700-2669-L 749.95
 1969 RH 700-2669-R 749.95
 1970 LH 700-2670-L 749.95
 1970 RH 700-2670-R 749.95



1971 LH (pictured) 700-2671-L 749.95
 1971 RH 700-2671-R 749.95
 1972 LH 700-2672-L 749.95
 1972 RH 700-2672-R 749.95

Dodge, except Charger



1968 LH (pictured) 700-2468-L 749.95
 1968 RH 700-2468-R 749.95
 1969 LH 700-2469-L 749.95
 1969 RH 700-2469-R 749.95

Plymouth



1968 LH (pictured) 700-1468-L 749.95
 1968 RH 700-1468-R 749.95
 1969 LH 700-1469-L 749.95
 1969 RH 700-1469-R 749.95
 1970 LH 700-1470-L 749.95
 1970 RH 700-1470-R 749.95



Check our Website for the Latest Updates:
[autometaldirect.com](http://www.autometaldirect.com)

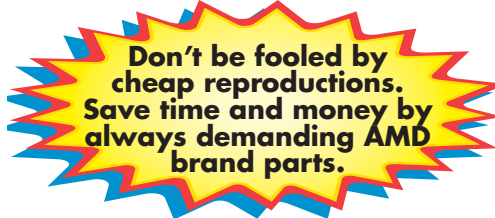

Don't be fooled by cheap reproductions. Save time and money by always demanding AMD brand parts.

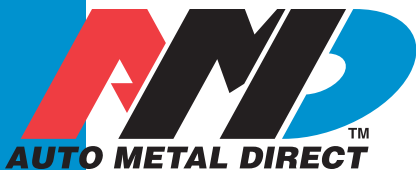

Our Name Says It All!™

www.autometaldirect.com

700) Quarter Panel, OE Style, continued

(Complete coverage like originals)

Plymouth



YEAR	MODEL	PART #	PRICE
1971	LH	700-1471-L	749.95
1971	RH	700-1471-R	749.95
1972	LH (pictured)	700-1472-L	749.95
1972	RH	700-1472-R	749.95

710) Quarter Panel Skin

Except for upper edge, our full skins will meet and attach to mating parts like OE (wheelhouse, door jamb, and tail light panel area). Top edge of panel bends over upper body line about 1/2 inch

Charger



1968	LH (pictured)	710-2668-L	349.95
1968	RH	710-2668-R	349.95
1969	LH	710-2669-L	349.95
1969	RH	710-2669-R	349.95
1970	LH	710-2670-L	349.95
1970	RH	710-2670-R	349.95
1971	LH	710-2671-L	349.95
1971	RH	710-2671-R	349.95
1972	LH	710-2672-L	349.95
1972	RH	710-2672-R	349.95

Dodge, except Charger



1968	LH (pictured)	710-2468-L	349.95
1968	RH	710-2468-R	349.95
1969	LH	710-2469-L	349.95
1969	RH	710-2469-R	349.95

Plymouth

63-65	LH	710-1463-L	349.95
63-65	RH	710-1463-R	349.95
66-67	LH	710-1466-L	349.95
66-67	RH	710-1466-R	349.95
73-74	LH	710-1473-L	349.95
73-74	RH	710-1473-R	349.95

710) Quarter Panel Skin, continued

Plymouth



1968	LH (pictured)	710-1468-L	349.95
1968	RH	710-1468-R	349.95
1969	LH	710-1469-L	349.95
1969	RH	710-1469-R	349.95
1970	LH	710-1470-L	349.95
1970	RH	710-1470-R	349.95
1971	LH	710-1471-L	349.95
1971	RH	710-1471-R	349.95
1972	LH	710-1472-L	349.95
1972	RH	710-1472-R	349.95

725) Quarter Panel Patch, Lower Front



Plymouth

71-72	LH	725-1471-L	199.95
71-72	RH	725-1471-R	199.95

750) Door Jamb Lock Pillar

Use when replacing quarter panel.

Sedan

68-70	LH	750-1468-1L	199.95
68-70	RH	750-1468-1R	199.95

Hardtop

68-70	LH	750-1468-2L	199.95
68-70	RH	750-1468-2R	199.95

Charger

68-70	LH (pictured)	750-2668-2L	199.95
68-70	RH	750-2668-2R	199.95



755) Quarter Panel Patch, Lower Rear

(Cut above side marker light where applicable)



Charger

1968	LH (pictured, left)	755-2668-L	199.95
1968	RH (pictured, right)	755-2668-R	199.95
1969	LH	755-2669-L	199.95
1969	RH	755-2669-R	199.95
1970	LH	755-2670-L	199.95
1970	RH	755-2670-R	199.95
1971	LH	755-2671-L	199.95
1971	RH	755-2671-R	199.95
1972	LH	755-2672-L	199.95
1972	RH	755-2672-R	199.95



Dodge, except Charger

1968	LH (pictured, left)	755-2468-L	199.95
1968	RH (pictured, right)	755-2468-R	199.95
1969	LH	755-2469-L	199.95
1969	RH	755-2469-R	199.95



MOPAR, JEEP, DODGE, HEMI, PLYMOUTH, and CHRYSLER are trademarks of Chrysler LLC used under license to Auto Metal Direct, LLC. © Chrysler LLC 2008

940 Sherwin Parkway, Suite 180
Buford, GA 30518

(866) 591-8309

755) Quarter Panel Patch, Lower Rear, continued

(Cut above side marker light where applicable)



Plymouth

63-65	LH	755-1463-L	199.95
63-65	RH	755-1463-R	199.95
66-67	LH	755-1466-L	199.95
66-67	RH	755-1466-R	199.95
1968	LH (pictured, left)	755-1468-L	199.95
1968	RH	755-1468-R	199.95
1969	LH (pictured, right)	755-1469-L	199.95
1969	RH	755-1469-R	199.95



1970	LH (pictured, left)	755-1470-L	199.95
1970	RH (pictured, right)	755-1470-R	199.95



1971	LH (large) (pictured, left)	755-1471-L	199.95
1971	RH (large) (pictured, right)	755-1471-R	199.95
1972	LH (large)	755-1472-L	199.95
1972	RH (large)	755-1472-R	199.95
73-74	LH	755-1473-L	199.95
73-74	RH	755-1473-R	199.95

760) Inner Wheelhouse



YEAR	MODEL	PART #	PRICE
66-70	LH	760-1466-L	159.95
66-70	RH	760-1466-R	159.95



71-74	LH	760-1471-L	159.95
71-74	RH	760-1471-R	159.95

761) Wheelhouse Vapor Canister Shield

Use when replacing LH wheelhouse



71-72	Front Section (pictured, left)	761-1471-1	29.95
71-72	Rear Section (pictured, right)	761-1471-2	39.95

TRUNK FLOORS

800) Trunk Floor, OE Style B-Body

62-65	800-1462	599.95
66-67	2 pieces	800-1466	389.95
68-70	800-1468	369.95
71-73	(modify for 74)	800-1471	369.95

Charger

68-70	800-2668	369.95
-------	-------	----------	--------

805) Trunk Floor Halves

(All split floors have lap seam, ready to weld)

B-Body

68-70	LH	805-1468-L	159.95
68-70	RH	805-1468-R	159.95
71-73	LH	805-1471-L	159.95
71-73	RH	805-1471-R	159.95

Charger

68-70	LH	805-2668-L	159.95
68-70	RH	805-2668-R	159.95



800-1462



800-1466



800-1468

Detail of differences in rear flange of Charger and B-Body trunk floors.



800-2668

Detail of lap seam on split floor sections.



805-1471-L

805-1471-R

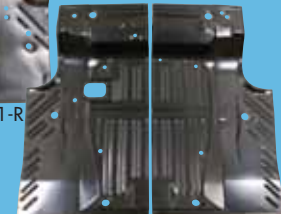

805-2668-L

805-2668-R



Our Name Says It All!™

www.autometaldirect.com

Some Items being developed are not in the catalog. Call for more information

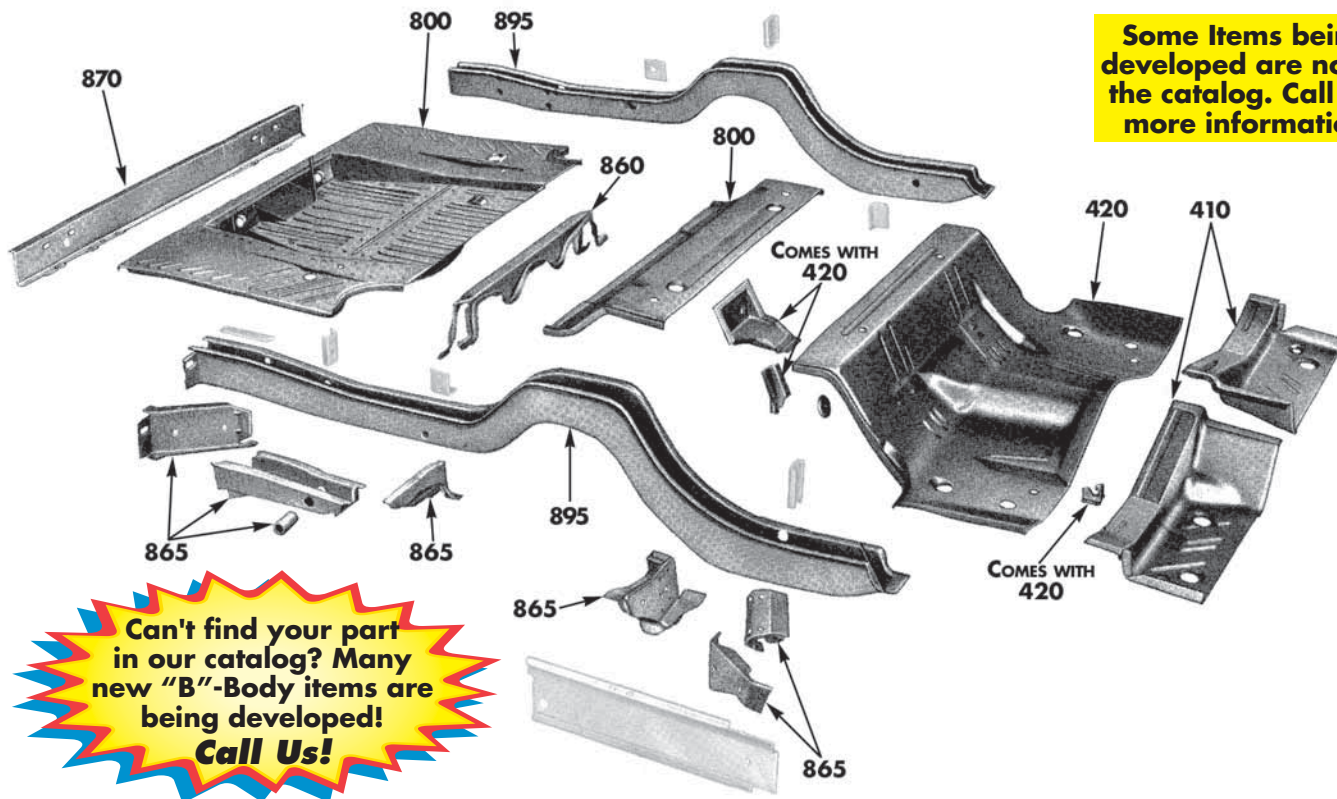

764) Package Tray Brace

(Attaches to inner wheel house)

Charger

68-70	Lower Brace, LH	764-2668-1L	19.95
68-70	Lower Brace, RH (pictured)	764-2668-1R	19.95



796) Quarter Glass Latch Assembly

68-70	Sedan, Pair	796-1468-P	139.95
-------	-------------	-------	------------	--------



770) Outer Wheelhouse

Use when replacing quarter panels



Dodge

YEAR	MODEL	PART #	PRICE
68-70	LH 770-2468-L	149.95
68-70	RH 770-2468-R	149.95

Plymouth

68-70	LH 770-1468-L	149.95
68-70	RH 770-1468-R	149.95
71-74	LH 770-1471-L	149.95
71-74	RH 770-1471-R	149.95

Charger

1971	LH (modify for 72-74) 770-2671-L	149.95
1971	RH (modify for 72-74) 770-2671-R	149.95

776) Quarter Panel

Lower Rear Corner

(Between Rear Valance and Quarter Panel)

New Tools! Correct Fit

68-70	Charger, LH 776-2668-L	79.95
68-70	Charger, RH 776-2668-R	79.95



810) Trunk Lock Support

Use when replacing trunk floor or taillight panel

Charger	68-70 (pictured, left) 810-2668	99.95
Dodge, except Charger	1969 810-2469	99.95
Plymouth	68-69 (pictured, center) 810-1468	59.95
	1970 (pictured, right) 810-1470	99.95



816) Spare Tire Stud, Wing Nut, Hardware Set

1968	All 816-1468-2S	29.95
68-74	Hardtop (with 70 or 78 Series spare) 816-1468-9S	29.95
68-70	Convertible (with 70 or 78 Series spare) 816-1468-7S	29.95
1970	Convertible (with 60 Series spare) 816-1468-9S	29.95
71-74	(with 60 Series spare) 816-1471-10S	29.95



Spare Tire Stud Wing Nut (Only)

Wing Nut Only 816-1468-1	9.95
---------------	------------------	------

795) Quarter Glass, see Glass Section, page 21



MOPAR, JEEP, DODGE, HEMI, PLYMOUTH, and CHRYSLER are trademarks of Chrysler LLC used under license to Auto Metal Direct, LLC. © Chrysler LLC 2008

940 Sherwin Parkway, Suite 180
Buford, GA 30518

(866) 591-8309

816) Spare Tire Stud, Wing Nut, Hardware Set, continued

Spare Tire Stud (Only)

1968 All (hook on bottom)	816-1468-2	19.95
Other Years, with bolt hole on bottom		
6" with 2 1/2" thread	816-1570-6	17.95
7 1/2" with 5 1/4" thread	816-1468-7	17.95
8" with 2 1/2" thread	816-1570-8	17.95
9 1/4" with 4 1/2" thread	816-1468-9	17.95
10 1/2" with 4 1/2" thread	816-1471-10	17.95

817) Spare Tire Hold Down Bracket

Use when replacing trunk floor



(All pictured, left to right)

62-65	817-1462	39.95
66-67	817-1466	19.95
1968	817-1468-1	39.95
69-70	817-1468-2	39.95
71-72 and 1970 Convertible	817-1471	19.95

Charger

Use when replacing trunk floor

68-70 Spare Tire Support, 2-piece set	817-2668-S	49.95
---------------------------------------	------------	-------

962) Trunk Floor to Valance Reinforcement

Use when replacing trunk floor



68-70 Charger, 2-piece set	962-2668-S	129.95
----------------------------	------------	--------

818) Jack Bracket

68-70 except Charger, includes wing nut (pictured, left)	818-1468-1S	24.95
71-73 2-piece set (pictured, right)	818-1471-S	29.95

Charger

68-70 LH, Front (spring hook) (pictured, above)	818-1570-1L	14.95
68-70 LH, Rear (pictured, below)	818-1570-2L	19.95
68-70 Front/Rear Brackets, 2-piece set	818-1570-S	29.95

820) Trunk Floor Brace

Required when replacing trunk floor

62-65 1 piece	820-1462	99.95
68-70 3-piece set	820-1468-S	129.95
71-73 2-piece set	820-1471-P	119.95

825) Trunk Gutter

Use when replacing quarter panel

Charger

YEAR	MODEL	PART #	PRICE
68-70	LH	825-2668-L	89.95
68-70	RH	825-2668-R	89.95
68-70	Pair	825-2668-P	169.95
71-74	LH	825-2671-L	99.95
71-74	RH	825-2671-R	99.95
71-74	Set	825-2671-S	189.95



Dodge, except Charger

68-70 Upper, LH	825-2468-1L	59.95
68-70 Upper, RH	825-2468-1R	59.95
1968 Lower, LH	825-2468-L	39.95
1968 Lower, RH	825-2468-R	39.95
1968 4-piece set	825-2468-S	189.95
1969 Lower, LH	825-2469-L	39.95
1969 Lower, RH	825-2469-R	39.95
1969 4-piece set (pictured)	825-2469-S	189.95

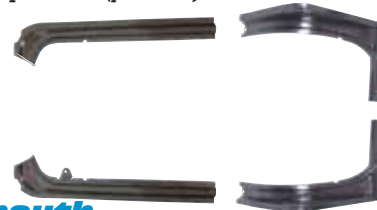

Plymouth

68-70 Upper, LH	825-1468-1L	69.95
68-70 Upper, RH	825-1468-1R	69.95
1968 Lower, LH	825-1468-L	42.95
1968 Lower, RH	825-1468-R	42.95
1968 Set of 4 (pictured)	825-1468-S	199.95
1969 Lower, LH	825-1469-L	42.95
1969 Lower, RH	825-1469-R	42.95
1969 Set of 4	825-1469-S	199.95
1970 Lower, LH	825-1470-L	29.95
1970 Lower, RH	825-1470-R	29.95
1970 Set of 4	825-1470-S	179.95
71-74 LH	825-1471-L	99.95
71-74 RH	825-1471-R	99.95
71-74 Set	825-1471-S	189.95

840) Trunk Floor Extensions

Use when replacing quarter panels and/or trunk floor



Dodge & Plymouth

(drop-off only, does not include small extension, see Sec. 841)

62-65 LH	840-1462-L	109.95
62-65 RH	840-1462-R	109.95



Dodge

68-70 LH	840-2468-L	129.95
68-70 RH	840-2468-R	129.95

Plymouth

68-70 LH (pictured)	840-1468-L	129.95
68-70 RH	840-1468-R	129.95
71-74 LH	840-1471-L	129.95
71-74 RH	840-1471-R	129.95

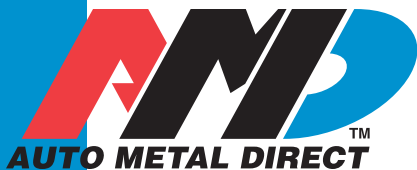

Our Name Says It All!™

www.autometaldirect.com

840) Trunk Floor Extensions, continued

Use when replacing quarter panels and/or trunk floor

Charger

YEAR	MODEL	PART #	PRICE
68-70	LH	840-2668-L	129.95
68-70	RH	840-2668-R	129.95
71-74	LH	840-2671-L	129.95
71-74	RH	840-2671-R	129.95

841) Trunk Floor Extension End Cap

63-65	Dodge, LH	841-2463-L	INQUIRE
63-65	Dodge, RH	841-2463-R	INQUIRE
63-65	Plymouth, LH	841-1463-L	INQUIRE
63-65	Plymouth, RH	841-1463-R	INQUIRE
71-74	LH	841-1471-L	19.95
71-74	RH (pictured)	841-1471-R	19.95



850) Deck Lid

Charger



68-69		850-2668	549.95
1970	with spoiler holes	850-2670	549.95

860) Upper Rear Crossmember (Shock Mount)



66-70		860-1466	249.95
-------	--	----------	--------

865) Rear Leaf Spring Mount



Dodge

66-70	LH, Front	865-1466-1L	119.95
66-70	RH, Front	865-1466-1R	119.95
66-70	LH, Rear	865-2466-2L	119.95
66-70	RH, Rear	865-2466-2R	119.95
66-70	Set of 4	865-2466-S	349.95

Plymouth

66-70	LH, Front	865-1466-1L	119.95
66-70	RH, Front	865-1466-1R	119.95
66-70	LH, Rear	865-1466-2L	119.95
66-70	RH, Rear	865-1466-2R	119.95
66-70	Set of 4 (pictured)	865-1466-S	349.95

870) Rear Crossmember



68-70		870-1468	199.95
-------	--	----------	--------

871) Rear Crossmember Extension

Dodge & Plymouth, except Charger

68-70	LH	871-1468-1L	17.95
68-70	RH (pictured)	871-1468-1R	17.95
Charger			
71-72	LH	871-2671-L	17.95
71-72	RH (pictured)	871-2671-R	17.95

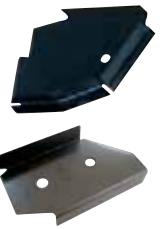

Reinforcement (welds on cross member)

Dodge & Plymouth, except Charger

68-70	LH (pictured)	871-1468-2L	22.95
68-70	RH	871-1468-2R	22.95



872) Quarter Panel Inner Reinforcement

Required when replacing quarter panels (fits in lower rear of quarter panel)

Charger

71-72	LH, Rear Support (pictured, top)	872-2671-L	39.95
71-72	RH, Rear Support (pictured, bottom)	872-2671-R	39.95
71-72	LH, Extension	872-2671-2L	39.95
71-72	RH, Extension	872-2671-2R	39.95
71-72	LH	872-2671-1L	39.95
71-72	RH	872-2671-1R	39.95



872-1471-1L 872-1471-1R 872-1471-2L 872-1471-2R

Plymouth

71-72	LH, Extension	872-1471-1L	39.95
71-72	RH, Extension	872-1471-1R	39.95
71-72	LH	872-1471-2L	39.95
71-72	RH	872-1471-2R	39.95

890) Gas Tanks

We now have a complete line of Spectra Premium Industries brand gas tanks. These tanks are the best on the market and have an OE appearance. All popular models in stock at competitive prices.



Dodge & Plymouth, except Charger

62-63	(with grommet)	890-1462	229.95
64-65	(without grommet)	890-1464	229.95
66-67		890-1466	229.95
68-70	except Charger (with 2 front vent pipes)	890-1468-2	229.95
1970	except Charger (with 4 side vent pipes)	890-1470-4	229.95
71-72	(with 4 side vent pipes)	890-1471	229.95
72-73	(with 4 front vent pipes)	890-1472	229.95
74-76		890-1474	379.95

Charger

68-70	without EEC (with 2 front vent pipes)	890-2668	229.95
-------	---------------------------------------	----------	--------

C-Body (full size)

67-73	(with 2 vent pipes)	890-1669-1	379.95
67-73	(with 4 vent pipes)	890-1669-2	379.95



MOPAR, JEEP, DODGE, HEMI, PLYMOUTH, and CHRYSLER are trademarks of Chrysler LLC used under license to Auto Metal Direct, LLC. © Chrysler LLC 2008

940 Sherwin Parkway, Suite 180
Buford, GA 30518

(866) 591-8309

895) Rear Frame Rail, OE Style



YEAR	MODEL	PART #	PRICE
68-70	LH	895-2468-L	399.95
68-70	RH	895-2468-R	399.95

900) Taillight Panel Charger



1968 with taillight brackets attached..... 900-2668 429.95



69-70 with taillight brackets attached..... 900-2669 429.95

Dodge, except Charger



1969 900-2469 429.95

Plymouth



1968 Lower Panel (below deck lid) 900-1468 199.95



1969 Lower Panel (below deck lid) 900-1469 199.95



1970 Complete OE style 900-1470 449.95

Outer Taillight Mount Plymouth

1968	LH	900-1468-L	69.95
1968	RH	900-1468-R	69.95
1969	LH (pictured)	900-1469-L	69.95
1969	RH	900-1469-R	69.95



920) Taillight Panel Reinforcement Brackets

Use when replacing taillight panel



69-70 Charger 920-2669-P 49.95

960) Rear Valance Charger



1968 960-2668 249.95



69-70 960-2669 249.95



71-72 without tips 960-2671 249.95



71-72 with tips 960-2671-T 249.95



73-74 without tips 960-2673 249.95



73-74 with tips 960-2673-T 249.95

Plymouth



1971 without tips 960-1471 249.95



1971 with tips 960-1471-T 249.95

962) Trunk Floor to Valance Reinforcement
Use when replacing trunk floor



68-70 Charger, 2-piece set 962-2668-S 129.95

970) Rear Bumper Bracket Set Charger



68-70 2 pieces 970-2668-S 129.95



68-69 Front/Rear/Center/Outer Set, 9 pieces..... 105-2668-1S 349.95

Dodge, except Charger



68-69 2 pieces 970-2468-S 129.95

68-69 Front/Rear set, 6 pieces 105-2468-1S 259.95

Plymouth

68-69 2 pieces 970-1468-S 129.95

68-69 Front/Rear Set, 6 pieces 105-1468-1S 259.95

1970 2 pieces 970-1470-S 129.95

1970 Front/Rear Set, 6 pieces 105-1470-1S 259.95

980) Rear Bumper Guards & Bumperettes

68-70 Charger,
Pair980-2668-P 129.95



**990) Rear Bumper
Charger**

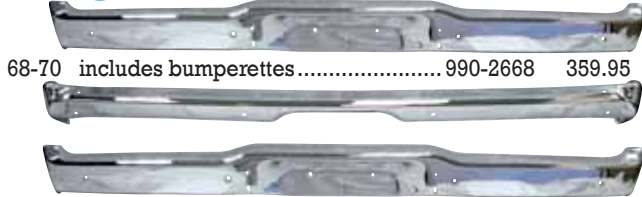

68-70 includes bumperettes 990-2668 359.95

68-69 Front/Rear Set,
includes bumperettes 100-2668-S 689.95

Dodge, except Charger

68-69 990-2468 399.95

Plymouth

1968 990-1468 399.95
1968 Front/Rear Set..... 100-1468-S 789.95



1969 990-1469 399.95
1969 Front/Rear Set..... 100-1469-S 789.95
1970 990-1470 399.95

101) Bumper Bolt Sets

(Bolt, Flat & Lock Washers, Nut)

16-piece set 101-1000-16S 9.95
24-piece set 101-1000-24S 12.95
32-piece set 101-1000-32S 14.95

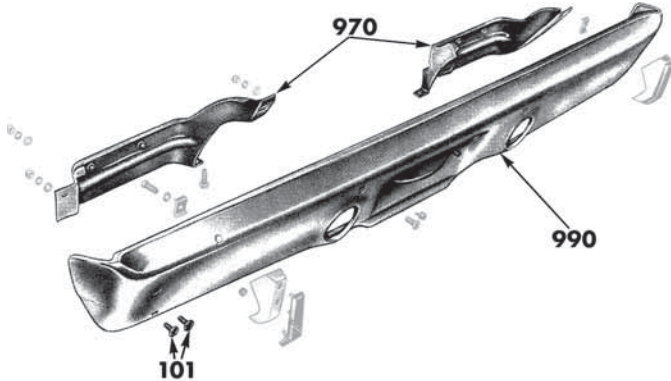

999) Emblems

(All emblems come with correct fasteners and have studs like OE.)

**New Tools!
Highest
Quality!**

Charger

Tail Panel Emblem



1969 "Charger" (pictured) 999-2669-91 32.95
1970 "Charger"..... 999-2670-91 32.95

Road Runner

Hood Emblem



1969 "383" 999-1469-31 24.95

Door Emblem



1968 "Road Runner" 999-1468-51 29.95

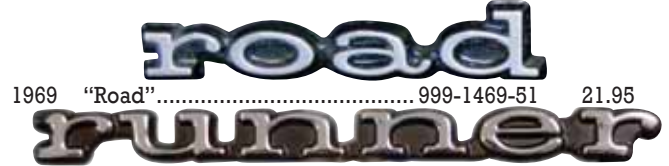

1969 "Road"..... 999-1469-51 21.95

1969 "Runner"..... 999-1469-52 21.95

1969 "Plymouth"..... 999-1470-91 84.95

Tail Panel Emblem



1970 "Plymouth"..... 999-1470-91 84.95

Superbee

Hood Emblem



69-70 "383", with fresh air hood 999-1469-31 24.95

AMD IS THE ANSWER...

...because rust never sleeps.

Don't be fooled by cheap reproductions. Save time and money by always demanding AMD brand parts.



AMD
AUTO METAL DIRECT
Our Name Says It All!™

Authentic Restoration Product

MOPAR, JEEP, DODGE, HEMI, PLYMOUTH, and CHRYSLER are trademarks of Chrysler LLC used under license to Auto Metal Direct, LLC. © Chrysler LLC 2008

940 Sherwin Parkway, Suite 180
Buford, GA 30518

(866) 591-8309

GLASS

Now you can finally get **quality** reproduction glass for your B-Body Dodge or Plymouth muscle car! For years restorers have been stuck with inaccurate reproduction glass. It was too thin, didn't fit, and lacked the authentic Mopar Pentastar logo. Here at Auto Metal Direct we know that details really do matter, so we are proud to offer the following glass selection, complete with Mopar logo, and **licensed by Chrysler!**
(Not date coded)

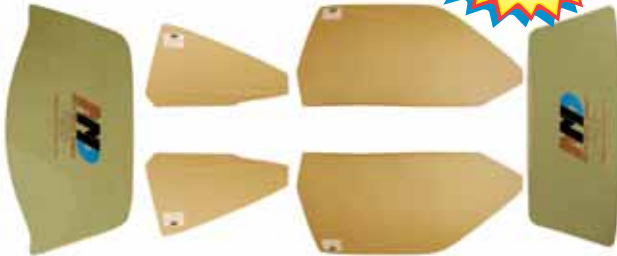

499) Complete Glass Kits
Hardtop, except Charger

68-70	Clear	499-1468-CS	1,299.95
68-70	Tinted	499-1468-TS	1,299.95
1971	Plymouth, Clear	499-1471-CS	1,199.95
1971	Plymouth, Tinted	499-1471-TS	1,199.95

Sedan

68-70	Dodge, Clear	499-2468-CSS	1,299.95
68-70	Dodge, Tinted	499-2468-TSS	1,299.95
68-70	Plymouth, Clear	499-1468-CSS	1,299.95
68-70	Plymouth, Tinted	499-1468-TSS	1,299.95

Charger

68-70	Clear	499-2668-CS	1,299.95
68-70	Tinted	499-2668-TS	1,299.95
1971	Clear	499-2671-CS	1,199.95
1971	Tinted	499-2671-TS	1,199.95



380) Windshield

YEAR	MODEL	PART #	PRICE
62-63	Clear	380-1462-C	249.95
62-63	Tinted	380-1462-T	249.95
64-65	Clear	380-1464-C	249.95
64-65	Tinted	380-1464-T	249.95
66-67	Clear	380-1466-C	249.95
66-67	Tinted	380-1466-T	249.95
68-70	Hardtop, Clear	380-1468-C	249.95
68-70	Hardtop, Tinted	380-1468-T	249.95
68-70	Convertible, Clear	380-1466-C	249.95
68-70	Convertible, Tinted	380-1466-T	249.95
71-74	Clear	380-1471-C	249.95
71-74	Tinted	380-1471-T	249.95



385) Windshield Molding Set

68-70	7-piece set	385-1468-S	249.95
-------	-------------	------------	--------



550) Door Glass

Hardtop

68-70	LH, Clear	550-1468-CL	199.95
68-70	RH, Clear	550-1468-CR	199.95
68-70	LH, Tinted	550-1468-TL	199.95
68-70	RH, Tinted	550-1468-TR	199.95
71-74	LH, Clear	550-1471-CL	199.95
71-74	RH, Clear	550-1471-CR	199.95
71-74	LH, Tinted	550-1471-TL	199.95
71-74	RH, Tinted	550-1471-TR	199.95

Sedan

68-70	LH, Clear	550-1468-CSL	199.95
68-70	RH, Clear	550-1468-CSR	199.95
68-70	LH, Tinted	550-1468-TSL	199.95
68-70	RH, Tinted	550-1468-TSR	199.95

560) Vent Glass

68-70	LH, Clear	560-1468-CL	89.95
68-70	RH, Clear	560-1468-CR	89.95
68-70	LH, Tinted	560-1468-TL	89.95
68-70	RH, Tinted	560-1468-TR	89.95



795) Quarter Glass

Hardtop

68-70	LH, Clear	795-1468-CL	149.95
68-70	RH, Clear	795-1468-CR	149.95
68-70	LH, Tinted	795-1468-TL	149.95
68-70	RH, Tinted	795-1468-TR	149.95

Dodge Sedan

68-70	LH, Clear	795-2468-CSL	149.95
68-70	RH, Clear	795-2468-CSR	149.95
68-70	LH, Tinted	795-2468-TSL	149.95
68-70	RH, Tinted	795-2468-TSR	149.95

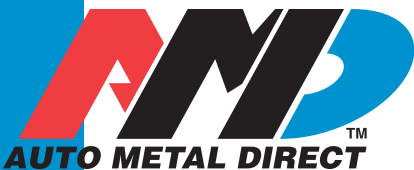

Our Name Says It All!™

www.autometaldirect.com

Now, get great-fitting glass for your Mopar muscle car, with this premium quality reproduction glass from the Mopar restoration professionals at Auto Metal Direct! Licensed by Chrysler, this glass includes the authentic Pentastar logo.



795) Quarter Glass, continued

Plymouth Hardtop

1971 LH, Clear.....	795-1471-CL	149.95
1971 RH, Clear.....	795-1471-CR	149.95
1971 LH, Tinted.....	795-1471-TL	149.95
1971 RH, Tinted.....	795-1471-TR	149.95
73-74 LH, Clear.....	795-1473-CL	149.95
73-74 RH, Clear.....	795-1473-CR	149.95
73-74 LH, Tinted.....	795-1473-TL	149.95
73-74 RH, Tinted.....	795-1473-TR	149.95

Plymouth Sedan

68-70 LH, Clear.....	795-1468-CSL	149.95
68-70 RH, Clear.....	795-1468-CSR	149.95
68-70 LH, Tinted.....	795-1468-TSL	149.95
68-70 RH, Tinted.....	795-1468-TSR	149.95

Charger

1971 LH, Clear.....	795-2671-CL	149.95
1971 RH, Clear.....	795-2671-CR	149.95
1971 LH, Tinted.....	795-2671-TL	149.95
1971 RH, Tinted.....	795-2671-TR	149.95

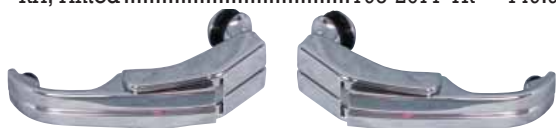

796) Quarter Glass Latch Assembly

68-70 Sedan, Pair.....	796-1468-P	139.95
------------------------	------------	--------



660) Back Glass

68-70 except Charger, Clear.....	660-1468-C	399.95
68-70 except Charger, Tinted.....	660-1468-T	399.95
71-74 Clear.....	660-1471-C	349.95
71-74 Tinted.....	660-1471-T	349.95

Charger

68-70 Clear.....	660-2668-C	349.95
68-70 Tinted.....	660-2668-T	349.95

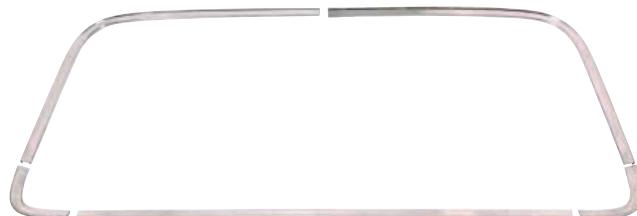

670) Rear Windshield Molding Set

68-70 except Charger.....	670-1468-S	249.95
68-70 Charger (pictured).....	670-2668-S	249.95

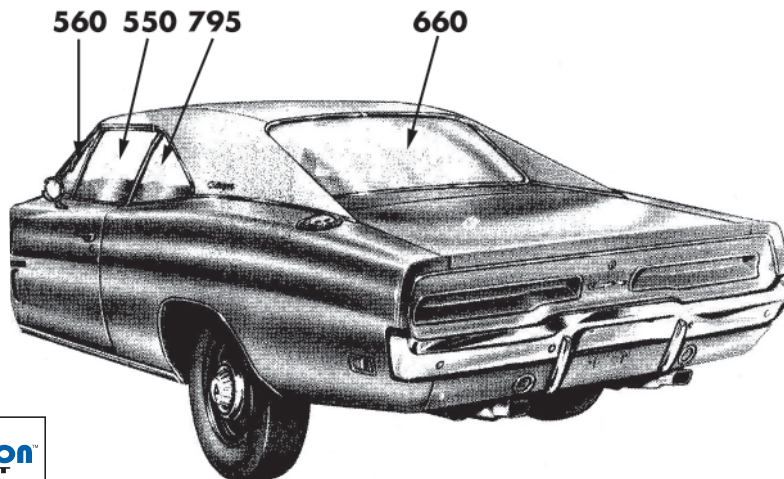
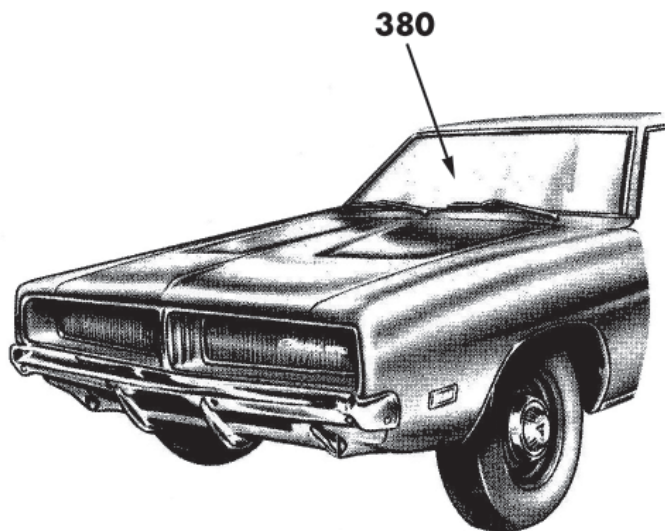

MOPAR, JEEP, DODGE, HEMI, PLYMOUTH, and CHRYSLER are trademarks of Chrysler LLC used under license to Auto Metal Direct, LLC. © Chrysler LLC 2008

940 Sherwin Parkway, Suite 180
Buford, GA 30518

(866) 591-8309

1970-74 "E" Body 2-Door

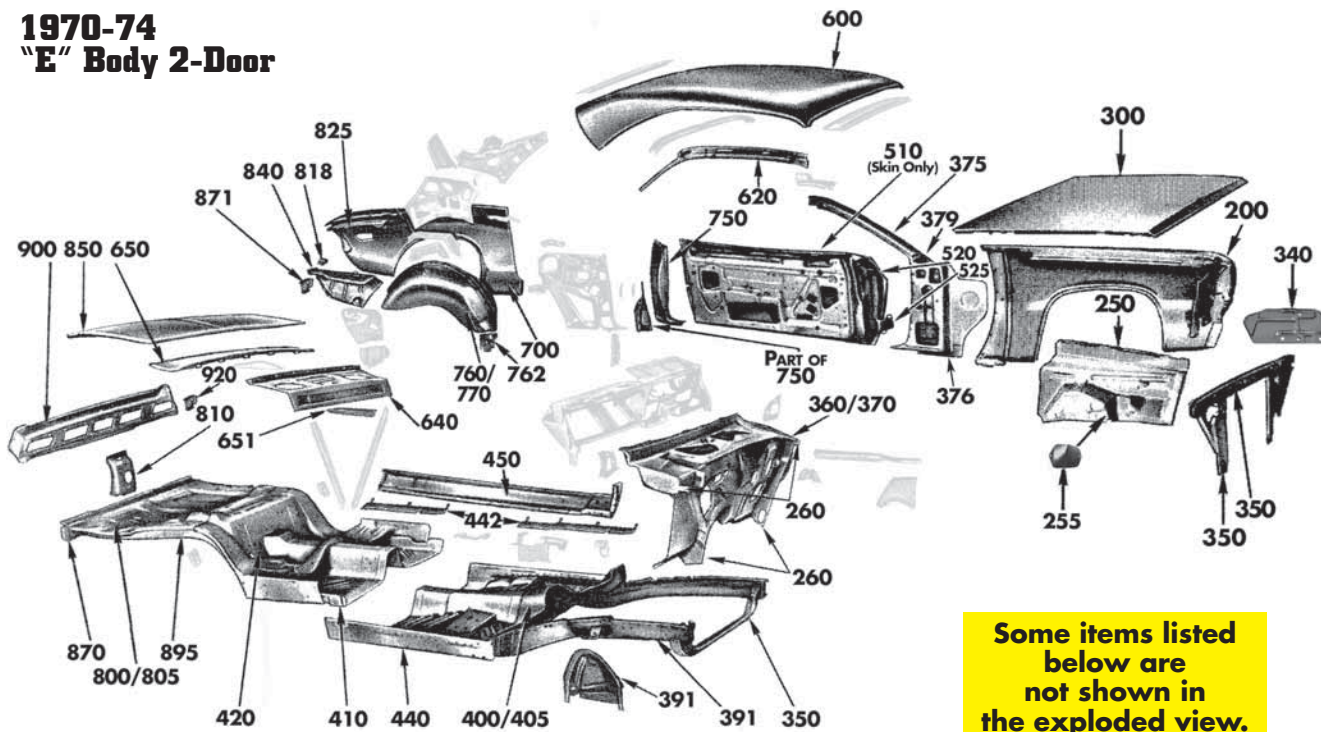

Some items listed below are not shown in the exploded view.

#	Part Description	Page #
100	Front Bumper	23
101	Bumper Bolt Set	24
105	Front Bumper Bracket Set	24
125	Front Valance	24
130	Header Panel	24
200	Front Fender	24
201	Fender Louver Set	25
205	Fender Patch, Lower Rear	25
250	Front Inner Fender	25
255	Front Inner Fender Cover/Plate	25
260	Inner Fender to Cowl Bracket	25
261	Fender to Cowl Bracket	25
300	Hood	25
310	Hood Hinges	25
320	Hood Insert Set	25
340	Battery Tray	25
350	Radiator Support	26
360	Firewall Upper Cowl	26
370	Firewall Lower Cowl	26
375	Windshield Post (A Pillar)	26
376	Cowl Side Hinge Panel	26
379	Windshield Corner/Cowl Patch	26
380	Windshield	35
391	Front Frame Rail	26
395	Torsion Bar Crossmember	26
400	Front Floor Pan	27
405	Front Floor Pan Halves	27
410	Rear Floor Pan/Footwell Area	27
415	Four-Speed Shifter Tunnel	27
420	Rear Floor Pan/Under Rear Seat	27
425	Main Floor Pan Support Set	27
426	Rear Floor Pan Reinforcement	27
441	Emergency Brake Cable Bracket	27
442	Floor Wiring Cover	27
440	Inner Rocker Panel	28
450	Outer Rocker Panel	28
490	Console Bracket Set	28
499	Complete Glass Kits	35
510	Door Shell	28
510	Door Skin	23
520	Door Hinge, upper	24
525	Door Hinge, lower	24
545	Window Regulators	24
550	Door Glass	35

#	Part Description	Page #
600	Roof Skin	29
620	Drip Rail, Pair	29
640	Package Tray	29
650	Deck Filler Panel	29
651	Deck Filler Panel Support	29
660	Back Glass	35
700	Quarter Panel, OE Style	29
710	Quarter Panel Skins	29
750	Door Jamb Pillar	30
760	Inner Wheelhouse	30
762	Inner Wheelhouse Bracket	30
770	Outer Wheelhouse	30
795	Quarter Glass	35
797	Quarter Glass Window Regulator	30
800	Trunk Floor	30
805	Trunk Floor Halves	30
810	Trunk Lock Support	31
816	Spare Tire Stud, Wing Nut, Hardware Kit	31
817	Spare Tire Hold Down Bracket	31
818	Jack Bracket	31
820	Trunk Floor Brace	31
825	Trunk Gutter	31
827	Trunk Lock Shield	32
840	Trunk Floor Extension	32
860	Upper Rear Crossmember (Shock Mount)	32
865	Rear Leaf Spring Mount	32
870	Rear Crossmember	32
871	Rear Crossmember Extension	32
885	Muffler Heat Shields	32
890	Gas Tanks	32
895	Rear Frame Rail	32
900	Taillight Panel	32
920	Taillight Panel Reinforcement Brackets	32
960	Rear Valance	33
961	Rear Valance Bracket Pair	33
970	Rear Bumper Bracket Set	33
975	Rear Bumper Filler	33
980	Rear Bumper Guards & Bumperettes	34
981	Rear Bumper Guard Brackets	34
990	Rear Bumper	34
999	Emblems	34

Don't be fooled by cheap reproductions. Save time and money by always demanding AMD brand parts.

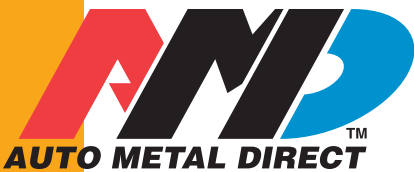

Our Name Says It All!™

www.autometaldirect.com

"E" BODY

In 1970, the whole world of car enthusiasts held their breath in anticipation of the all-new E-Body Mopar.

Dodge

Challenger
Challenger R/T

Plymouth

Barracuda
'Cuda

LH = Driver Side

RH = Passenger Side



FRONT BUMPERS

The bumpers on Challenger and 'Cuda noses added real style to a classic design. But that thin shape made them vulnerable to dents and damage. For years restorers have had to rely on expensive restorations of rare original cores, and today most junk yards and swap meets have been stripped bare. But today you can order beautiful new licensed reproduction bumpers for your E-Body from AMD. Get bumper brackets, too. All our brackets have pentastars and part numbers. Call today!

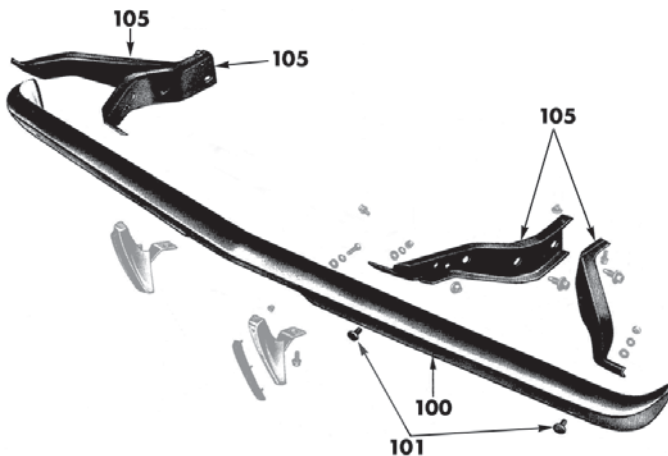

100) Front Bumper Barracuda

YEAR	MODEL	PART #	PRICE
70-71	without jack slots	100-1570	279.95
70-71	without jack slots, Front/Rear Set ...	100-1570-S	519.95
1972	with jack slots	100-1572	279.95
1972	with jack slots, Front/Rear Set	100-1572-S	519.95
73-74	100-1573	279.95
1973	Front/Rear Set.....	100-1573-S	519.95
1974	Front/Rear Set.....	100-1574-S	519.95

Challenger

70-71	100-2570	279.95
70-71	Front/Rear Set.....	100-2570-S	519.95
1972	100-2572	279.95
1972	Front/Rear Set.....	100-2572-S	519.95
73-74	100-2573	279.95
1973	Front/Rear Set.....	100-2573-S	519.95
1974	Front/Rear Set.....	100-2574-S	519.95



MOPAR, JEEP, DODGE, HEMI, PLYMOUTH, and CHRYSLER are trademarks of Chrysler LLC used under license to Auto Metal Direct, LLC. © Chrysler LLC 2008

940 Sherwin Parkway, Suite 180
Buford, GA 30518

(866) 591-8309

101) Bumper Bolt Sets

(Bolt, Flat & Lock Washers, Nut)

16-piece set.....	101-1000-16S	9.95
24-piece set.....	101-1000-24S	12.95
32-piece set.....	101-1000-32S	14.95



105) Front Bumper Bracket Sets

Barracuda



70-72 Front set, 4 pieces.....	105-1570-S	169.95
--------------------------------	------------	--------



70-72 Front/Rear set, 6 pieces.....	105-1570-1S	274.95
-------------------------------------	-------------	--------

Challenger



70-72 Front set, 4 pieces.....	105-2570-S	169.95
--------------------------------	------------	--------



70-72 Front/Rear set, 6 pieces.....	105-2570-1S	274.95
-------------------------------------	-------------	--------

125) Front Valance

Barracuda



1970, 1972-74	125-1570	229.95
---------------------	----------	--------



1971	125-1571	349.95
------------	----------	--------

125) Front Valance, continued

Challenger



70-71	125-2570	229.95
72-74	125-2572	229.95

130) Header Panel

Barracuda



1970	130-1570	399.95
------------	----------	--------



1971 (pictured).....	130-1571	299.95
72-74	130-1572	299.95

200) Front Fender

Barracuda



1970 LH.....	200-1570-L	649.95
1970 RH.....	200-1570-R	649.95



1971 LH, no gills.....	200-1571-1L	649.95
1971 RH, no gills.....	200-1571-1R	649.95
1971 LH, with gills (pictured).....	200-1571-2L	649.95
1971 RH, with gills.....	200-1571-2R	649.95
72-74 LH.....	200-1572-L	649.95
72-74 RH.....	200-1572-R	649.95

Challenger



All products are **AMP** exclusives and are made on our own steel tools.

1970 LH.....	200-2570-L	649.95
1970 RH.....	200-2570-R	649.95
1971 LH.....	200-2571-L	649.95
1971 RH.....	200-2571-R	649.95
72-74 LH (pictured).....	200-2572-L	649.95
72-74 RH.....	200-2572-R	649.95



Our Name Says It All!™

www.autometaldirect.com

201) Fender Louver Set

1971 Cuda, with gills.....201-1571-S 239.95



205) Fender Patch, Lower Rear

(Includes brace)

Barracuda

70-74 LH..... 205-1570-L 129.95
70-74 RH.....205-1570-R 129.95

Challenger

70-74 LH..... 205-2570-L 129.95
70-74 RH.....205-2570-R 129.95

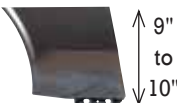

250) Front Inner Fender, OE Style



70-71 LH..... 250-1570-L 209.95
70-71 RH.....250-1570-R 209.95
70-71 Pair (pictured).....250-1570-P 399.95
72-74 LH..... 250-1572-L 209.95
72-74 RH.....250-1572-R 209.95
72-74 Pair.....250-1572-P 399.95

255) Front Inner Fender Cover/Plate

70-74 Pair.....255-1570-P 19.95



260) Inner Fender to Cowl Bracket

Use when replacing inner fender or cowl

70-74 LH, upper (pictured) .260-1570-2L 39.95
70-74 RH, upper260-1570-2R 39.95
70-74 Pair, upper260-1570-2P 74.95
70-74 LH, lower..... 260-1570-L 49.95
70-74 RH, lower260-1570-R 49.95
70-74 Pair, lower (pictured)...260-1570-P 89.95



Inner Fender Brace to Cowl Bracket

70-74 Pair (pictured)260-1570-1P 39.95

261) Fender to Cowl Bracket

70-74 LH (pictured).....261-1570-L 19.95
70-74 RH.....261-1570-R 19.95
70-74 Pair.....261-1570-P 37.95



310) Hood Hinges



YEAR	MODEL	PART #	PRICE
70-74	Pair, includes springs.....	310-1570-P	249.95

320) Hood Insert Set

(Includes block-off plates)



70-74 Challenger R/T 320-2570-S 189.95

340) Battery Tray

(Correct reproductions of original style trays)



70-74 340-1570 29.95



HOODS

NEW LOWER PRICES!

Replace the rusted, bent, or missing original Hood on your 'Cuda, or Challenger, with these beautiful brand new, top quality reproduction Hoods from craftsmen who really know Dodge and Plymouth muscle cars.

300) Hood

300-1570-2S

Barracuda, Shaker Hood

Includes trim ring

70-74 without pin holes 300-1570-2S 899.95
70-74 with pin holes300-1570-2HS 899.95

Challenger RT

70-74 without pin holes300-2570-1 499.95
70-74 with pin holes300-2570-1H 499.95

Challenger, Shaker Hood

Includes trim ring

70-74 without pin holes 300-2570-2S 899.95
70-74 with pin holes300-2570-2HS 899.95

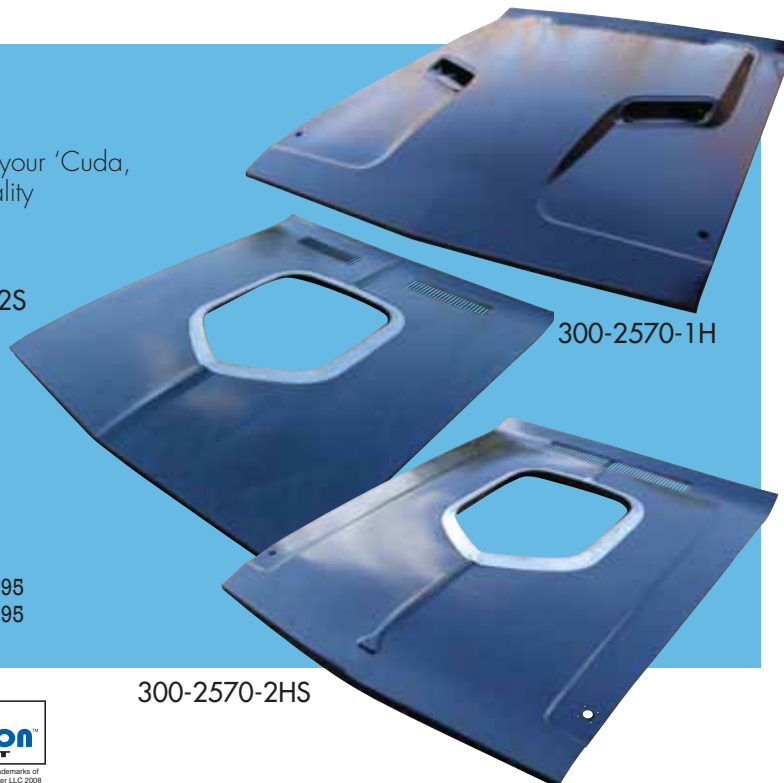

940 Sherwin Parkway, Suite 180
Buford, GA 30518

(866) 591-8309

350) Radiator Support

(Lower section is not welded to assembly for ease of installation.)



YEAR	MODEL	PART #	PRICE
70-74	Assembly.....	350-1570-S	349.95
70-74	Lower.....	351-1570	199.95

360) Firewall Upper Cowl

(See Upper / Lower Sets under Section 370)



70-74	screw-on screen style	360-1570-1	399.95
70-74	Square holes for screen mounting (clip on screen style)	360-1570-2	499.95

370) Firewall Lower Cowl



70-74	without A/C	370-1570	499.95
-------	-------------------	----------	--------



70-74	with A/C	370-1570-AC	499.95
-------	----------------	-------------	--------

Save \$\$\$ when you buy as a set!

Upper/Lower Sets



70-74	without A/C, (screw-on screen style)	370-1570-1S	849.95
70-74	without A/C, (clip-on screen style)	370-1570-2S	849.95
70-74	with A/C, (screw-on screen style).....	370-1570-1ACS	849.95
70-74	with A/C, (clip-on screen style).....	370-1570-2ACS	849.95

375) Windshield Post (A Pillar)

(runs from roof joint to upper door hinge area. Outer skin only.)

70-74	LH (pictured at right)...	375-1570-L	159.95
70-74	RH.....	375-1570-R	159.95

376) Cowl Side Hinge Panel



(All pictured, left to right)

70-74	Outer, LH	376-1570-1L	199.95
70-74	Outer, RH	376-1570-1R	199.95
70-74	Inner, LH	376-1570-2L	199.95
70-74	Inner, RH	376-1570-2R	199.95

379) Windshield Corner/Cowl Patch

(repairs rust in corner of windshield)

70-74	LH.....	379-1570-L	99.95
70-74	RH (pictured)	379-1570-R	99.95
70-74	4-piece set.....	379-1570-S	189.95

380) Windshield - see Glass Section, page 35

391) Front Frame Rail, OE Style



70-74	LH.....	391-1570-L	499.95
70-74	RH.....	391-1570-R	499.95

395) Torsion Bar Crossmember



1970	395-1570	399.95
------	-------	----------	--------

Will fit 71-72, but emergency brake cable was moved from the 70 location. Will fit 73-74 but the transmission mounting bracket from the 70-72 vehicle must be used.

400) Front Floor Pan, OE Style

(complete coverage, like original)



Comes with fastener for speedometer cable

YEAR	MODEL	PART #	PRICE
1970	(with flange)	400-1570	499.95
71-74		400-1571	499.95

405) Front Floor Pan Halves

(Does not include top area of transmission tunnel)



1970	LH, with flange	405-1570-L	199.95
1970	RH, with flange	405-1570-R	199.95
71-74	LH	405-1571-L	199.95
71-74	RH	405-1571-R	199.95

410) Rear Floor Pan/Footwell Area, OE Style

(Connects to Full Floor Pan to give complete OE style floor coverage.)



Side view - 1970

Side view - 1971-74

Barracuda

1970	LH	410-1570-L	129.95
1970	RH	410-1570-R	129.95
1970	Pair	410-1570-P	199.95
71-74	LH	410-1571-L	129.95
71-74	RH	410-1571-R	129.95
71-74	Pair	410-1571-P	199.95

410) Rear Floor Pan/Footwell Area, OE Style, continued

Challenger

1970	LH	410-2570-L	129.95
1970	RH	410-2570-R	129.95
1970	Pair	410-2570-P	199.95
71-74	LH	410-2571-L	129.95
71-74	RH	410-2571-R	129.95
71-74	Pair	410-2571-P	199.95

415) Four-Speed Shifter Tunnel



70-74 (with or without console)415-1570 149.95

420) Rear Floor Pan/ Under Rear Seat



Underside

Includes brackets for emergency brake cable, exhaust hanger and pinion snubber welded in place.

70-74 420-1570 399.95

425) Main Floor Pan Supports

Use when replacing floor pan



70-74 4-piece set..... 425-1570-S 129.95

426) Rear Floor Pan Reinforcement

Use when replacing rear floor pan

70-74 Pair 426-1570 39.95



437) Rocker to Frame Lower Splash Shield

70-74	LH (2 pieces)	437-1570-L	INQUIRE
70-74	RH (2 pieces)	437-1570-R	INQUIRE

441) Emergency Brake Cable Bracket

Use when replacing floor pan

1970 Only 441-1570 24.95



442) Floor Wiring Cover

Use when replacing floor pan

Barracuda			
70-74	2-piece set	442-1570-S	99.95

Challenger			
70-74	2-piece set	442-2570-S	99.95



MOPAR, JEEP, DODGE, HEMI, PLYMOUTH, and CHRYSLER are trademarks of Chrysler LLC used under license to Auto Metal Direct, LLC. © Chrysler LLC 2008

940 Sherwin Parkway, Suite 180
Buford, GA 30518

(866) 591-8309

440) Inner Rocker Panel



Cuda

YEAR	MODEL	PART #	PRICE
1970	LH.....	440-1570-L	149.95
1970	RH.....	440-1570-R	149.95
71-74	LH.....	440-1571-L	149.95
71-74	RH.....	440-1571-R	149.95

Challenger

1970	LH.....	440-2570-L	149.95
1970	RH.....	440-2570-R	149.95
71-74	LH.....	440-2571-L	149.95
71-74	RH.....	440-2571-R	149.95

450) Rocker Panel (Outer skin or sill)



Barracuda

70-74	LH.....	450-1570-L	299.95
70-74	RH.....	450-1570-R	299.95

Challenger

70-74	LH.....	450-2570-L	299.95
70-74	RH.....	450-2570-R	299.95

451) Rocker Box / Rocker End Cap

(Fits on front end of rocker panel)

70-74	LH, Front.....	451-1570-L	17.95
70-74	RH, Front.....	451-1570-R	17.95



490) Console Bracket Set

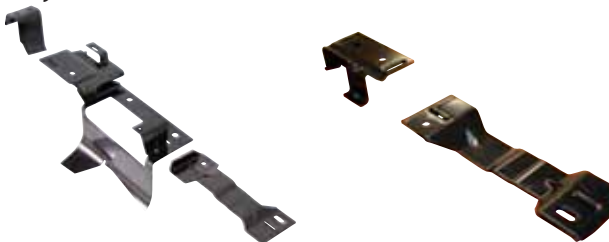

70-74	Automatic Transmission, 3 pieces (pictured, left).....	490-1570-AS	149.95
70-74	Manual Transmission, 2 pieces (pictured, right).....	490-1570-MS	89.95

499) Complete Glass Kits - see page 35

500) Door Shell

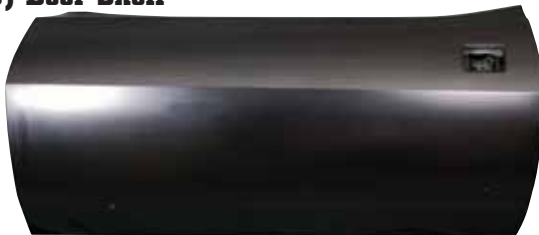

Barracuda

70-74	2-Door and Convertible, LH.....	500-1570-L	599.95
70-74	2-Door and Convertible, RH.....	500-1570-R	599.95

500) Door Shell, continued



Challenger

YEAR	MODEL	PART #	PRICE
70-74	2-Door and Convertible, LH.....	500-2570-L	599.95
70-74	2-Door and Convertible, RH.....	500-2570-R	599.95

510) Door Skin



Barracuda

70-74	LH.....	510-1570-L	299.95
70-74	RH.....	510-1570-R	299.95



Challenger

70-74	LH.....	510-2570-L	299.95
70-74	RH.....	510-2570-R	299.95

520) Door Hinge, upper

NEW! Not Rebuilt

70-74	Upper, LH.....	520-1570-L	69.95
70-74	Upper, RH.....	520-1570-R	69.95
70-74	Upper / Lower set, 4 pieces.....	520-1570-S	229.95



525) Door Hinge, lower

70-74	Lower, LH.....	525-1570-L	89.95
70-74	Lower, RH.....	525-1570-R	89.95
70-74	Upper / Lower set, 4 pieces.....	520-1570-S	229.95



545) Window Regulator



Barracuda

70-74	LH.....	545-1570-L	199.95
70-74	RH (pictured).....	545-1570-R	199.95

Challenger

70-74	LH.....	545-2570-L	199.95
70-74	RH.....	545-2570-R	199.95

550) Door Glass - see Glass Section, page 35

600) Roof Skin, OE Style



70-74 Barracuda 600-1570 599.95



70-74 Challenger 600-2570 599.95

IN DEVELOPMENT:
under roof structure including area around back window.

620) Drip Rail, Pair

Use when replacing roof skin



70-74 Barracuda 620-1570-S 199.95

70-74 Challenger (pictured) 620-2570-S 199.95

640) Package Tray (Speaker panel)



Barracuda

70-74 640-1570 349.95



Challenger

70-74 640-2570 349.95

650) Deck Filler Panel



70-74 Barracuda 650-1570 169.95

70-74 Challenger (pictured) 650-2570 169.95

651) Deck Filler Support

Use when replacing deck filler panel and/or package tray

70-74 Barracuda (left) 651-1570 29.95
70-74 Challenger (right) 651-2570 29.95



700) Quarter Panel, OE Style

(complete coverage like originals)

Barracuda



All products are **AMP** exclusives and are made on our own steel tools.

70-71 LH (pictured) 700-1570-L 599.95
70-71 RH 700-1570-R 599.95
72-74 LH 700-1572-L 599.95
72-74 RH 700-1572-R 599.95

Challenger



70-71 LH 700-2570-L 599.95
70-71 RH 700-2570-R 599.95
72-74 LH (pictured) 700-2572-L 599.95
72-74 RH 700-2572-R 599.95

710) Quarter Panel Skin

Except for upper edge, our full skins will meet and attach to mating parts like OE (wheelhouse, door jamb, and tail light panel area). Top edge of panel bends over upper body line about 1/2 inch

Barracuda



70-71 LH (pictured) 710-1570-L 299.95
70-71 RH 710-1570-R 299.95
72-74 LH 710-1572-L 299.95
72-74 RH 710-1572-R 299.95

Challenger



70-71 LH 710-2570-L 299.95
70-71 RH 710-2570-R 299.95
72-74 LH (pictured) 710-2572-L 299.95
72-74 RH 710-2572-R 299.95



940 Sherwin Parkway, Suite 180
Buford, GA 30518

(866) 591-8309

750) Door Jamb Lock Pillar

Use when replacing quarter panel

Barracuda

70-74 LH	750-1570-L	199.95
70-74 RH	750-1570-R	199.95

Challenger

70-74 LH	750-2570-L	199.95
70-74 RH (pictured)	750-2570-R	199.95



760) Inner Wheelhouse



YEAR	MODEL	PART #	PRICE
70-74	LH	760-1570-L	139.95
70-74	RH	760-1570-R	139.95

762) Inner Wheelhouse Bracket

(Seat Belt Anchor)

Use when replacing inner wheel houses

70-71	Front, LH	762-1570-L	19.95
70-71	Front, RH	762-1570-R	19.95
70-71	Front, Pair (pictured)	762-1570-P	34.95

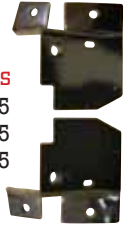

770) Outer Wheelhouse

Use when replacing quarter panels



Barracuda

70-74 LH	770-1570-L	149.95
70-74 RH	770-1570-R	149.95

Challenger

70-74 LH (pictured, left)	770-2570-L	149.95
70-74 RH (pictured, right)	770-2570-R	149.95

755) Quarter Panel Patch, Lower Rear

(Cut above side marker light where applicable)

Barracuda

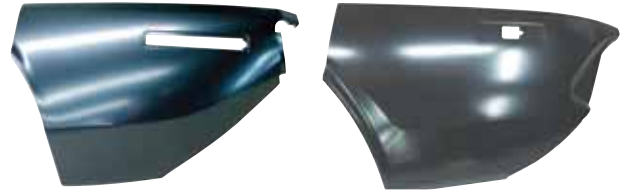

70-71 LH (pictured, left)	755-1570-L	169.95
70-71 RH	755-1570-R	169.95
72-74 LH	755-1572-L	169.95
72-74 RH	755-1572-R	169.95

Challenger

70-71 LH	755-2570-L	169.95
70-71 RH	755-2570-R	169.95
72-74 LH (pictured, right)	755-2572-L	169.95
72-74 RH	755-2572-R	169.95

Can't find your part in our catalog? Many new "E"-Body items are being developed! Call Us!

795) Quarter Glass - see page 35

TRUNK FLOORS

800) Trunk Floor, OE Style

Barracuda

1970	800-1570	369.95
71-74	800-1571	369.95

Challenger

1970	800-2570	369.95
71-74	800-2571	369.95

805) Trunk Floor Halves

(All split floors have lap seam, ready to weld)

Barracuda

1970 LH Side	805-1570-L	159.95
1970 RH Side	805-1570-R	159.95
71-74 LH Side	805-1571-L	159.95
71-74 RH Side	805-1571-R	159.95

Challenger

1970 LH	805-2570-L	159.95
1970 RH	805-2570-R	159.95
71-74 LH	805-2571-L	159.95
71-74 RH	805-2571-R	159.95

Trunk Floors available in Full OE Style or split versions.



800-1570

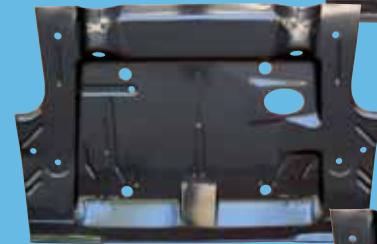

800-2571

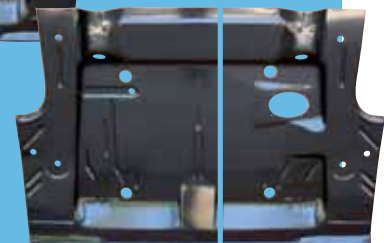

805-2571-L

805-2571-R

Detail of lap seam on split floor sections.



797) Quarter Glass Window Regulator Bracket

(Allows quarter windows to roll up and down smoothly)

70-74 LH=RH 797-1570-S 19.95



810) Trunk Lock Support

Use when replacing trunk floor or taillight panel



YEAR	MODEL	PART #	PRICE
70-74	Barracuda (pictured, left)	810-1570	99.95
70-74	Challenger (pictured, right)	810-2570	99.95

816) Spare Tire Stud, Wing Nut, Hardware Set

70-74	with full size spare	816-1570-6S	29.95
70-74	with Space Saver spare	816-1570-8S	29.95

Spare Tire Stud Wing Nut (Only)

Wing Nut Only	816-1468	9.95
---------------	----------	------

Spare Tire Stud (Only)

(with bolt hole on bottom)

6" with 2 1/2" thread	816-1570-6	17.95
8" with 2 1/2" thread	816-1570-8	17.95



817) Spare Tire Hold Down Bracket

70-74	Hardtop (pictured, left)	817-1570-1	29.95
70-71	Convertible (pictured, right)	817-1570-2	49.95

818) Jack Bracket

70-74	LH, Front (spring hook) (pictured, above)	818-1570-1L	14.95
70-74	LH, Front Bracket, mounts on wheel house (pictured, center)	818-1570-3L	19.95
70-74	LH, Rear (pictured, below)	818-1570-2L	19.95
70-74	Front/Rear Brackets, 2-piece set	818-1570-S	29.95

820) Trunk Floor Brace

Required when replacing trunk floor

70-74	Pair	820-1570-P	119.95
-------	------	------------	--------

DECK LIDS

Did you know that there were **several different deck lid configurations for Challengers and Barracudas?** So why settle for a "one-style-fits-all" replacement? Here at Auto Metal Direct, we've gone the extra mile to produce the finest E-Body deck lids on the market, and **we offer five different deck lid configurations.** Call and order the correct deck lid for your E-Body today!

850) Deck Lid

BARRACUDA

70-74	without spoiler holes	850-1570-1	499.95
1970	with spoiler holes	850-1570-2	499.95
1971	with spoiler holes	850-1571	499.95

CHALLENGER

70-74	without spoiler holes	850-2570-1	499.95
70-71	with spoiler holes	850-2570-2	499.95

Don't waste time and money trying to fix an inferior quality piece. Do it right the first time. AMD deck lids are the smart choice.



940 Sherwin Parkway, Suite 180
Buford, GA 30518

(866) 591-8309

825) Trunk Gutter

Use when replacing quarter panel



Barracuda

YEAR	MODEL	PART #	PRICE
70-74	LH	825-1570-L	74.95
70-74	RH	825-1570-R	74.95
70-74	Set (pictured)	825-1570-S	139.95

Challenger

70-74	LH	825-2570-L	74.95
70-74	RH	825-2570-R	74.95
70-74	Pair	825-2570-S	139.95

827) Trunk Lock Shield

Use when replacing taillight panel



70-71	Barracuda	827-1570	85.95
-------	-----------	----------	-------

840) Trunk Floor Extension

Use when replacing quarter panel



Barracuda

70-74	LH	840-1570-L	129.95
70-74	RH	840-1570-R	129.95

Challenger (pictured)

70-74	LH	840-2570-L	129.95
70-74	RH	840-2570-R	129.95

860) Upper Rear Crossmember (Shock Mount)



70-74		860-1570	239.95
-------	--	----------	--------

865) Rear Leaf Spring Mount



70-74	LH, Front	865-1570-1L	119.95
70-74	RH, Front	865-1570-1R	119.95

870) Rear Crossmember



70-74		870-1570	199.95
-------	--	----------	--------

871) Rear Crossmember Extension

70-74	LH	871-1570-L	17.95
70-74	RH (pictured)	871-1570-R	17.95



885) Muffler Heat Shields

70-74 E-Body, Galvanized, Pair (pictured).....885-1570-S 59.95



NEW TOOLS!
Correct Appearance

890) Gas Tank

We now have a complete line of Spectra Premium Industries brand gas tanks. These tanks are the best on the market and have an OE appearance. All popular models in stock at competitive prices.



Barracuda

1970	(1 side vent pipe)	890-1570-1	229.95
71-72	(4 side vent pipes)	890-1571	229.95
72-74	(4 front vent pipes)	890-1570-4	229.95

Challenger

1970	(without vent pipe)	890-2570	229.95
71-72	(with 4 side vent pipes)	890-2571-4	229.95
72-74	(with 4 front vent pipes)	890-2570-4	229.95

895) Rear Frame Rail, OE Style

(Comes with loose emergency brake cable brackets for 1970 and 1971-74)



70-74	LH	895-1570-L	379.95
70-74	RH	895-1570-R	379.95

900) Taillight Panel

Barracuda

(1972 and 73-74 versions come with taillight brackets attached)



70-71		900-1570	449.95
-------	--	----------	--------



1972		900-1572	449.95
------	--	----------	--------



73-74		900-1573	449.95
-------	--	----------	--------

Challenger



1970		900-2570	449.95
------	--	----------	--------

920) Taillight Panel Reinforcement Brackets

Required when replacing taillight panel or quarter panel.



Barracuda

70-74	Pair	920-1570-S	89.95
-------	------	------------	-------

REAR VALANCES

Did you know that there were **six different rear valance panels for E-Body Barracudas?** So why settle for a "one-style-fits-all" replacement? Here at Auto Metal Direct, we've gone the extra mile to duplicate **all 6 versions of the panels.** Call and order the correct rear valance panel for your E-Body today!

960) Rear Valance Panels Barracuda



1970 without tips 960-1570 249.95



1970 with tips 960-1570-T 249.95



71-72 without tips 960-1571 249.95



71-72 with tips 960-1571-T 249.95



73-74 without tips 960-1573 249.95



73-74 with tips 960-1573-T 249.95

Challenger



70-71 without tips 960-2570 249.95



70-71 with tips 960-2570-T 249.95



72-74 without tips 960-2572 249.95



72-74 with tips 960-2572-T 249.95

961) Rear Valance Brackets

Required when replacing valance panels.

Barracuda

1970 Pair (pictured, at right) ... 961-1570 99.95

71-74 Pair (pictured, above left) 961-1571 29.95

Challenger

70-71 Pair (pictured, right) 961-2570 99.95

72-74 Challenger brackets are welded onto the valance itself, so no additional brackets are required.



970) Rear Bumper Bracket Set



Barracuda

70-72 2 pieces 970-1570-S 129.95



70-72 Front/Rear Set, 6 pieces 105-1570-1S 274.95

Challenger



70-72 2 pieces 970-2570-S 129.95



70-72 Front/Rear Set, 6 pieces 105-2570-1S 274.95

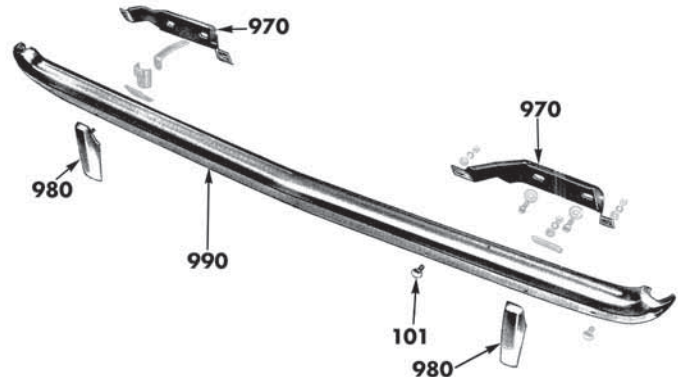

MOPAR, JEEP, DODGE, HEMI, PLYMOUTH, and CHRYSLER are trademarks of Chrysler LLC used under license to Auto Metal Direct, LLC. © Chrysler LLC 2008

940 Sherwin Parkway, Suite 180
Buford, GA 30518

(866) 591-8309

975) Rear Bumper Filler
(between bumper and taillight panel)

70-72 Challenger	975-2570	59.95
------------------------	----------	-------

980) Rear Bumper Guards & Bumperettes

Barracuda

70-72 Pair	980-1570-P	129.95
------------------	------------	--------

Challenger

70-72 Pair (pictured).....	980-2570-P	129.95
----------------------------	------------	--------



981) Rear Bumper Guard Brackets

Barracuda

70-72 (4-piece set) (pictured, above).....	981-1570-S	34.95
---	------------	-------



Challenger

70-72 (4-piece set) (pictured, below).....	981-2570-S	34.95
---	------------	-------



990) Rear Bumper

Barracuda

70-71	990-1570	279.95
-------------	----------	--------

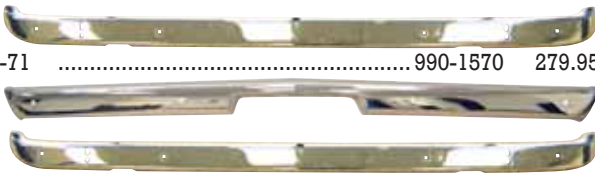

70-71 Front/Rear Set.....	100-1570-S	519.95
1972	990-1572	279.95
1972 Front/Rear Set.....	100-1572-S	519.95
1973	990-1573	279.95
1973 Front/Rear Set.....	100-1573-S	519.95
1974 with jack slots.....	990-1574	279.95
1974 Front/Rear Set.....	100-1574-S	519.95

Challenger

NEW TOOLS!
Good Quality!



70-71	990-2570	279.95
70-71 Front/Rear Set.....	100-2570-S	519.95
1972	990-2572	279.95
1972 Front/Rear Set.....	100-2572-S	519.95
1973	990-2573	279.95
1973 Front/Rear Set.....	100-2573-S	519.95
1974	990-2574	279.95
1974 Front/Rear Set.....	100-2574-S	519.95

101) Bumper Bolt Sets

(Bolt, Flat & Lock Washers, Nut)

16-piece set.....	101-1000-16S	9.95
24-piece set.....	101-1000-24S	12.95
32-piece set.....	101-1000-32S	14.95



999) Emblems

(All emblems come with correct fasteners and have studs like OE.)

Challenger

Grille Emblem



1970 "Challenger".....	999-2570-11	40.95
------------------------	-------------	-------

Fender Emblem



70-74 "Challenger".....	999-2570-21	38.95
-------------------------	-------------	-------

New Tools!
Highest Quality!

WE INSTALL WHAT WE SELL!

You already know that you can get premium sheet metal parts for your muscle car from Auto Metal Direct (AMD). Our panels fit and include all correct-as-original clips, tabs, flanges, bends and seams.

We are so confident in the quality and fit of our parts, that we have developed our own installation center! Cars that were formally written off as hopeless have now been given a new lease on life. And since we are actually installing our own parts, we are able to develop parts that fit correctly.



**Auto Metal Direct...
Saving Cars &
Preserving History**



AMD Installation Center

7314 Hwy 115 E. • Cleveland, Ga 30528

Call Us at: **(706) 348-6653**

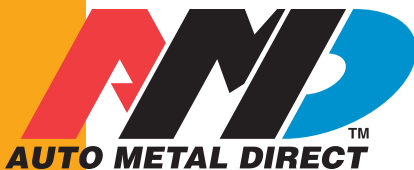

Our Name Says It All!™

www.autometaldirect.com

GLASS

Now you can finally get **quality** reproduction glass for your E-Body Dodge or Plymouth muscle car! For years restorers have been stuck with inaccurate reproduction glass. It was too thin, didn't fit, and lacked the authentic Mopar Pentastar logo. Here at Auto Metal Direct we know that details really do matter, so we are proud to offer the following glass selection, complete with Mopar logo, and licensed by Chrysler! (Not date coded)

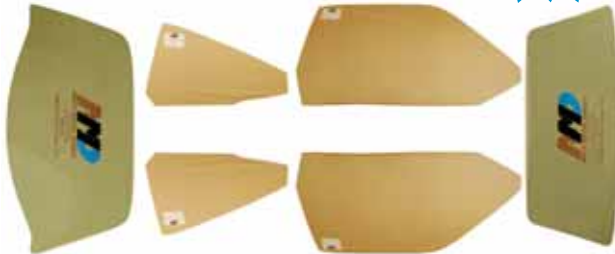

499) Complete Glass Kits Barracuda

YEAR	MODEL	PART #	PRICE
70-74	Clear	499-1570-CS	1,199.95
70-74	Tinted	499-1570-TS	1,199.95

Challenger

70-74	Clear	499-2570-CS	1,199.95
70-74	Tinted	499-2570-TS	1,199.95

Convertible

70-74	Clear	499-1570-CVS	1,149.95
70-74	Tinted	499-1570-TVS	1,149.95

Now, get great-fitting glass for your Mopar muscle car, with this premium quality reproduction glass from the Mopar restoration professionals at Auto Metal Direct! Licensed by Chrysler, this glass includes the authentic Pentastar logo.



380) Windshield

70-74	Clear	380-1570-C	249.95
70-74	Tinted	380-1570-T	249.95

550) Door Glass

70-74	LH, Clear	550-1570-CL	199.95
70-74	RH, Clear	550-1570-CR	199.95
70-74	LH, Tinted	550-1570-TL	199.95
70-74	RH, Tinted	550-1570-TR	199.95

Convertible

70-74	LH, Clear	550-1570-CVL	299.95
70-74	RH, Clear	550-1570-CVR	299.95
70-74	LH, Tinted	550-1570-TVL	299.95
70-74	RH, Tinted	550-1570-TVR	299.95

795) Quarter Glass

Barracuda

70-74	LH, Clear	795-1570-CL	149.95
70-74	RH, Clear	795-1570-CR	149.95
70-74	LH, Tinted	795-1570-TL	149.95
70-74	RH, Tinted	795-1570-TR	149.95

Challenger

70-74	LH, Clear	795-2570-CL	149.95
70-74	RH, Clear	795-2570-CR	149.95
70-74	LH, Tinted	795-2570-TL	149.95
70-74	RH, Tinted	795-2570-TR	149.95

Convertible

70-74	LH, Clear	795-1570-CVL	199.95
70-74	RH, Clear	795-1570-CVR	199.95
70-74	LH, Tinted	795-1570-TVL	199.95
70-74	RH, Tinted	795-1570-TVR	199.95

797) Quarter Glass

Window Regulator Bracket

(Allows quarter windows to roll up and down smoothly)

70-74	LH=RH	797-1570-S	19.95
-------	-------	------------	-------



660) Back Glass

Barracuda

70-74	Clear	660-1570-C	349.95
70-74	Tinted	660-1570-T	349.95

Challenger

70-74	Clear	660-2570-C	349.95
70-74	Tinted	660-2570-T	349.95

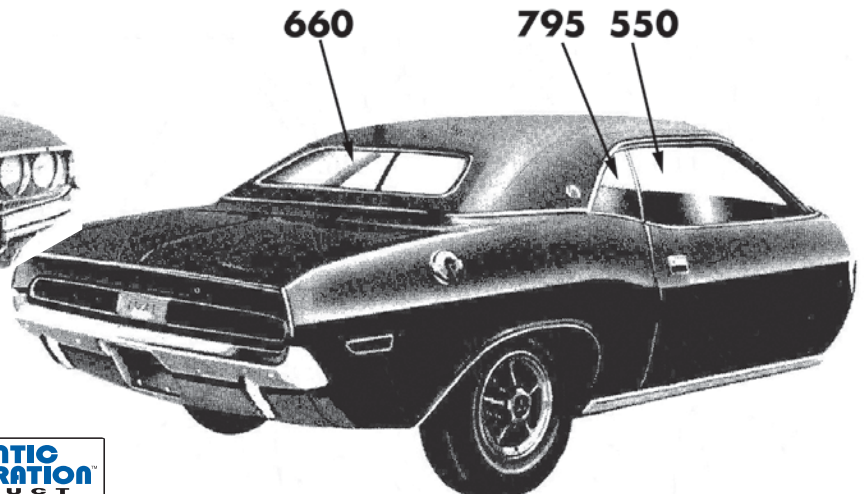

940 Sherwin Parkway, Suite 180
Buford, GA 30518

(866) 591-8309

1967-76 "A" Body 2-Door

All products are **AM** exclusives and are made on our own steel tools.

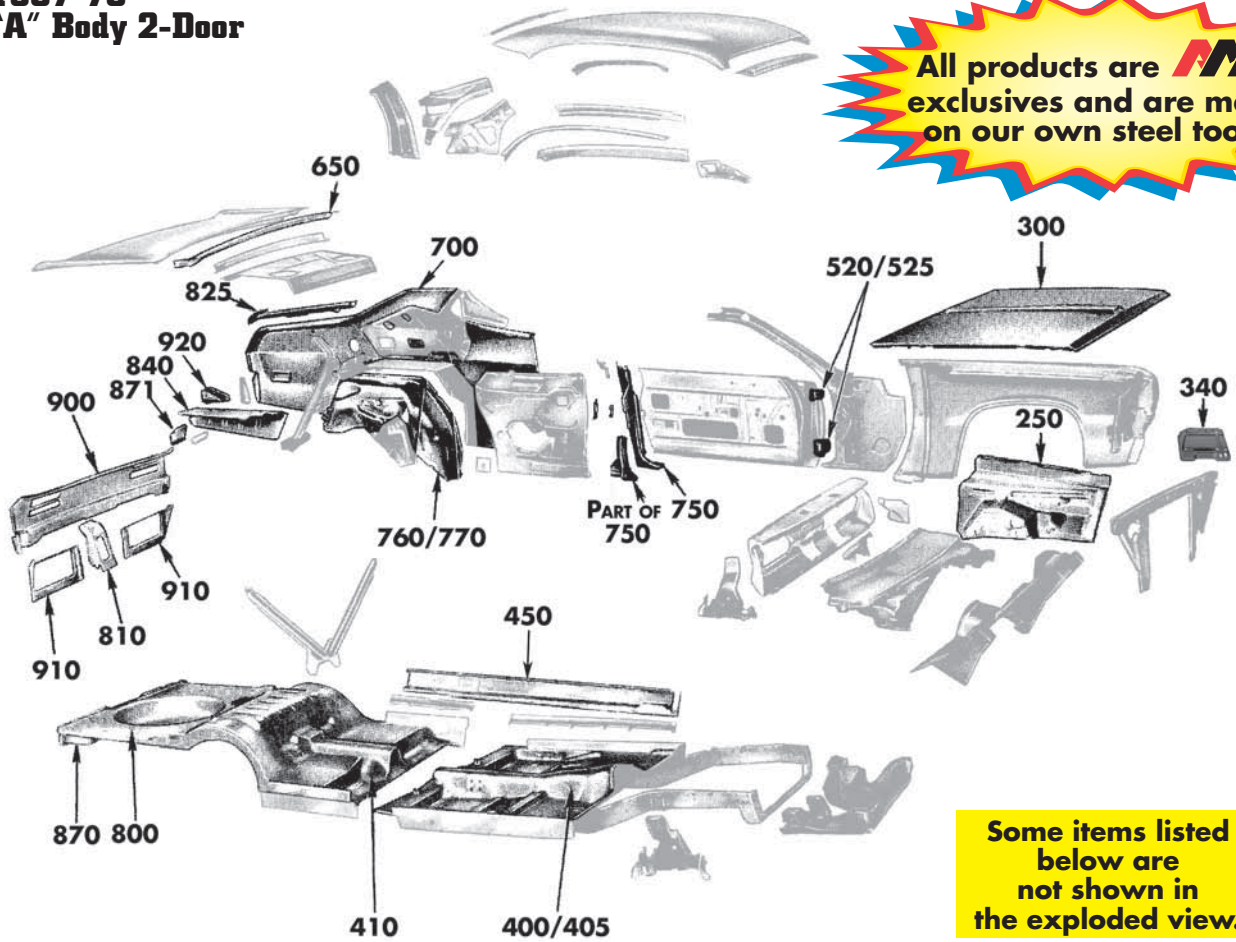

#	Part Description	Page #
100	Front Bumper	37
101	Bumper Bolt Sets	37
105	Front Bumper Bracket Set	37
106	Front Stabilizer Bracket (Corner)	38
125	Front Valance	38
205	Fender Patch, Lower Rear	38
250	Front Inner Fender	38
251	Front Rear Splash Shields	38
300	Hood	38
340	Battery Tray	38
400	Front Floor Pan	38
380	Windshield	42
405	Front Floor Pan Halves	38
410	Rear Floor Pan/Footwell Area	38
415	Four-Speed Shifter Tunnel	39
450	Outer Rocker	39
451	Rocker Box / Rocker End Cap	39
499	Complete Glass Kits	42
520	Door Hinge, upper	39
525	Door Hinge, lower	39
550	Door Glass	42
560	Vent Glass	43
650	Deck Filler Panel	39
660	Back Glass	43
700	Quarter Panel OE Style	39
710	Quarter Panel Skin	39
750	Door Jamb Lock Pillar	40
755	Quarter Panel Patch, Lower Rear	40
760	Inner Wheelhouse	40
770	Outer Wheelhouse	40
795	Quarter Glass	43
800	Trunk Floor	40
810	Trunk Lock Support	40

#	Part Description	Page #
825	Trunk Gutter	40
840	Trunk Floor Extension	40
841	Trunk Floor Extension End Cap	40
842	Trunk Floor Extension Brace	41
860	Upper Rear Crossmember (Shock Mount)	41
865	Rear Leaf Spring Mount	41
870	Rear Crossmember	41
871	Rear Crossmember Extension	41
890	Gas Tanks	41
895	Rear Frame Rail	41
900	Taillight Panel	41
910	Taillight Brackets	41
920	Taillight Panel Reinforcement Brackets	41
960	Rear Valance	41
970	Rear Bumper Bracket Set	41
990	Rear Bumper & Bumperettes	42

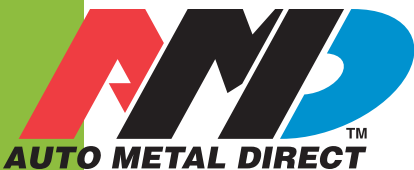
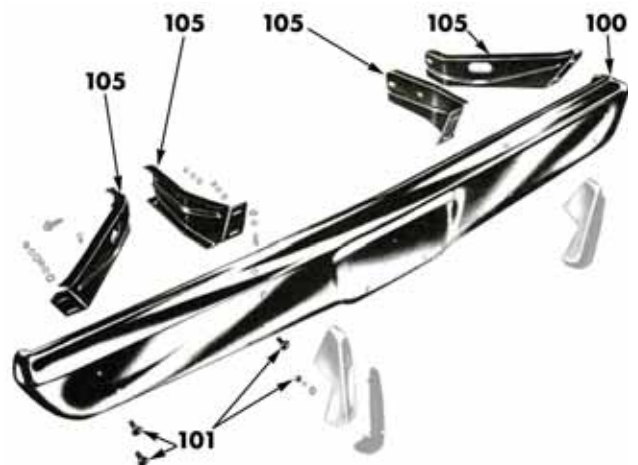

Our Name Says It All!™

www.autometaldirect.com

"A" BODY

With light weight bodies and hot motors, A-Body Dodge and Plymouth muscle cars quickly became favorites with muscle car lovers. The 273, 318, 340, and 360 engines are the stuff of legend today, and Chrysler's unique slant-six has to be the unchallenged king of all inline six cylinder engines. Add these great engines to stylish body designs, low initial purchase price, and available factory graphics and it's easy to see why these A-Body cars were so popular. Today you can finally get top quality Chrysler-licensed reproduction body panels for your Dodge or Plymouth A-Body, from the restoration professionals at Auto Metal Direct. **Call now!**

Dodge

Dart
Demon
Dart Sport

Plymouth

Barracuda (1967-69 only)
Duster
Valiant

LH = Driver Side

RH = Passenger Side



100) Front Bumper

Barracuda



67-69 also fits rear 100-1267 309.95

67-69 Front/Rear Set..... 100-1267-S 609.95

Dart

67-69 100-2067 279.95

70-71 without jack slots 100-2070 279.95

Can fit 1972 but requires 1970-71 style jack hook

Demon

1971 without jack slots 100-2070 279.95

Can fit 1972 but requires 1970-71 style jack hook

Duster



70-71 without jack slots 100-1370 309.95

70-71 without jack slots, Front/Rear Set... 100-1370-S 609.95

71-72 with jack slots 100-1371 309.95

71-72 with jack slots, Front/Rear Set..... 100-1371-S 609.95

101) Bumper Bolt Sets

(Bolt, Flat & Lock Washers, Nut)

16-piece set 101-1000-16S 9.95

24-piece set 101-1000-24S 12.95

32-piece set 101-1000-32S 14.95



105) Front Bumper Bracket Set



Barracuda

67-69 4 pieces 105-1267-S 129.95

67-69 Front/Rear/Outer Set, 10 pieces

(pictured)..... 105-1267-1S 239.95

Dart

67-69 4 pieces 105-2067-S 109.95

67-69 Front/Rear Set, 6 pieces..... 105-2067-1S 189.95



Duster

70-72 4 pieces (pictured)..... 105-1370-S 109.95

70-72 Front/Rear Set, 8 pieces..... 105-1370-1S 189.95

106) Stabilizer Bracket

(between fender and bumper)

Barracuda

67-69 Pair (also fits rear)..... 106-1267-S 19.95

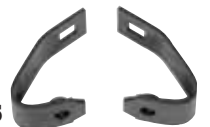

MOPAR, JEEP, DODGE, HEMI, PLYMOUTH, and CHRYSLER are trademarks of Chrysler LLC used under license to Auto Metal Direct, LLC. © Chrysler LLC 2008

940 Sherwin Parkway, Suite 180
Buford, GA 30518

(866) 591-8309

125) Front Valance



Barracuda

67-69 125-1267 229.95



Dart / Demon

70-72 Dart 125-2070 229.95
71-72 Demon 125-2070 229.95

205) Fender Patch, Lower Rear

(Includes brace)

Barracuda

67-69 LH 205-1267-L 109.95
67-69 RH 205-1267-R 109.95

Dart

67-69 LH 205-2067-L 109.95
67-69 RH 205-2067-R 109.95
70-72 LH 205-2070-L 109.95
70-72 RH 205-2070-R 109.95



Duster

70-76 LH 205-1370-L 109.95
70-76 RH 205-1370-R 109.95

250) Front Inner Fender



67-74 LH 250-1067-L 209.95
67-74 RH 250-1067-R 209.95
67-74 Pair 250-1067-P 389.95

251) Fender Rear Splash Shields

Barracuda

67-69 Pair 251-1267-P 149.95

Dart

67-72 Pair 251-2067-P 149.95

Duster

70-76 Pair 251-1370-P 149.95



300) Hood



68-69 Dart GTS, GT & Swinger, also fits 1967 300-2067 599.95

340) Battery Tray *(Correct reproductions of original style trays)*



63-66 *(pictured, left)* 340-1063 39.95
67-74 *(pictured, right)* 340-1067 29.95

380) Windshield - see Glass Section, page 42

400) Front Floor Pan, OE Style

(Complete coverage like original, comes with fastener for speedometer cable)



Barracuda

67-69 400-1267 429.95

Duster/Demon

70-74 *(modify for 75-76)* 400-1267 429.95



Dart

(OE Style, does not cover footwell area. See Section 410, below)

67-74 *(modify for 75-76)* 400-1067 379.95

405) Front Floor Pan, halves



Barracuda

67-69 LH 405-1267-L 174.95
67-69 RH 405-1267-R 174.95

Dart *(pictured)*

67-74 LH *(modify for 75-76)* 405-1067-L 149.95
67-74 RH *(modify for 75-76)* 405-1067-R 149.95

Duster / Demon

70-74 LH *(modify for 75-76)* 405-1267-L 174.95
70-74 RH *(modify for 75-76)* 405-1267-R 174.95

410) Rear Floor Pan/Footwell Area, OE Style

(Connects to Full Floor Pan to give complete OE style floor coverage.)



67-74 Dart, LH 410-1067-L 59.95
67-74 Dart, RH 410-1067-R 59.95

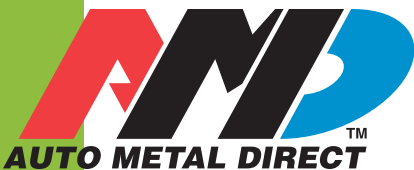

415) Four-Speed Shifter Tunnel



67-74 (with or without console) 415-1067 149.95

440) Inner Rockers (In development, please inquire)

450) Outer Rocker



Dart

67-76 LH 450-2067-L 249.95
67-76 RH 450-2067-R 249.95

Duster

70-76 LH 450-1370-L 249.95
70-76 RH 450-1370-R 249.95

451) Rocker Box / Rocker End Cap

(Fits on front end of rocker panel)

67-76 LH (front) 451-1067-L 17.95
67-76 RH (front) 451-1067-R 17.95



499) Complete Glass Sets, see page 42

510) Door Skins

Barracuda

67-69 LH 510-1267-L *INQUIRE*
67-69 RH 510-1267-R *INQUIRE*

Dart

67-76 LH 510-2067-L *INQUIRE*
67-76 RH 510-2067-L *INQUIRE*

Duster

70-76 LH 510-1370-L *INQUIRE*
70-76 RH 510-1370-R *INQUIRE*

Demon

71-72 LH 510-1370-L *INQUIRE*
71-72 RH 510-1370-R *INQUIRE*

520) Door Hinge, upper

67-74 LH 520-1067-L 59.95
67-74 RH 520-1067-R 59.95



Upper/Lower Set

67-74 4 pieces 520-1067-S 199.95

NEW!
Not Rebuilt

525) Door Hinge, lower

67-74 LH 525-1466-L 89.95
67-74 RH 525-1466-R 89.95



550) Door Glass & 560) Vent Glass, see page 42

650) Deck Filler Panel



67-76 Dart 650-2067 149.95
70-76 Duster 650-1370 *INQUIRE*

Will fit 74-76 with slight modification

654) Deck Filler Patch, Inner/Lower



67-76 Dart, LH 654-2067-2L 29.95
67-76 Dart, RH 654-2067-2R 29.95

700) Quarter Panel, OE Style

(complete coverage like original)



Dart

1967 LH (pictured) 700-2067-L 499.95
1967 RH 700-2067-R 499.95
1968 LH 700-2068-L 499.95
1968 RH 700-2068-R 499.95
1969 LH 700-2069-L 499.95
1969 RH 700-2069-R 499.95



Dart

70-71 LH (pictured) 700-2070-L 499.95
70-71 RH 700-2070-R 499.95
72-76 LH 700-2072-L 499.95
72-76 RH 700-2072-R 499.95
72-76 Dart Sport, LH 700-1372-L 499.95
72-76 Dart Sport, RH 700-1372-R 499.95



Duster / Demon

70-71 LH 700-1370-L 499.95
70-71 RH 700-1370-R 499.95
72-76 LH 700-1372-L 499.95
72-76 RH 700-1372-R 499.95

710) Quarter Panel Skin

Except for upper edge, our full skins will meet and attach to mating parts like OE (wheelhouse, door jamb, and tail light panel area). Top edge of panel bends over upper body line about 1/2 inch

Barracuda

67-69 Fits all models, LH 700-1267-L 279.95
67-69 Fits all models, RH 700-1267-R 279.95

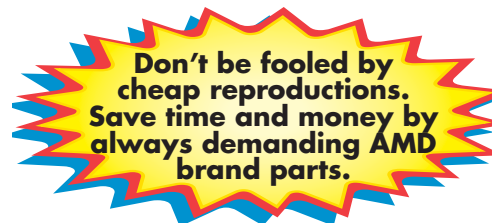

MOPAR, JEEP, DODGE, HEMI, PLYMOUTH, and CHRYSLER are trademarks of Chrysler LLC used under license to Auto Metal Direct, LLC. © Chrysler LLC 2008

940 Sherwin Parkway, Suite 180
Buford, GA 30518

(866) 591-8309

710) Quarter Panel Skin, continued



Dart

1967 LH (pictured).....	710-2067-L	279.95
1967 RH.....	710-2067-R	279.95
1968 LH.....	710-2068-L	279.95
1968 RH.....	710-2068-R	279.95
1969 LH.....	710-2069-L	279.95
1969 RH.....	710-2069-R	279.95
70-71 LH.....	710-2070-L	279.95
70-71 RH.....	710-2070-R	279.95
72-76 LH.....	710-2072-L	279.95
72-76 RH.....	710-2072-R	279.95



Duster / Demon

70-71 LH (pictured).....	710-1370-L	279.95
70-71 RH.....	710-1370-R	279.95
72-76 and Dart Sport, LH.....	710-1372-L	279.95
72-76 and Dart Sport, RH.....	710-1372-R	279.95

750) Door Jamb Lock Pillar

Use when replacing quarter panel

Dart

67-76 LH.....	750-2067-L	199.95
67-76 RH.....	750-2067-R	199.95
73-76 Dart Sport, LH.....	750-1370-L	199.95
73-76 Dart Sport, RH.....	750-1370-R	199.95



Duster / Demon

70-76 LH (pictured).....	750-1370-L	199.95
70-76 RH.....	750-1370-R	199.95

755) Quarter Panel Patch, Lower Rear

(Cut above side marker light where applicable)

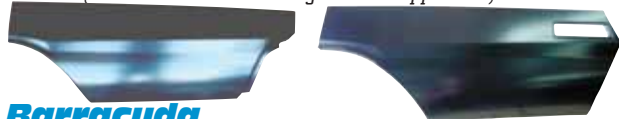

Barracuda

67-69 LH.....	755-1267-L	149.95
67-69 RH.....	755-1267-R	149.95

Dart

1967 LH (pictured, left).....	755-2067-L	149.95
1967 RH.....	755-2067-R	149.95
1969 LH.....	755-2069-L	149.95
1969 RH.....	755-2069-R	149.95
70-71 LH (pictured, right).....	755-2070-L	149.95
70-71 RH.....	755-2070-R	149.95
72-76 LH.....	755-2072-L	149.95
72-76 RH.....	755-2072-R	149.95

Duster / Demon

70-71 LH.....	755-1370-L	149.95
70-71 RH.....	755-1370-R	149.95
72-76 and Dart Sport, LH.....	755-1372-L	149.95
72-76 and Dart Sport, RH.....	755-1372-R	149.95

760) Inner Wheelhouse



67-73 LH.....	760-1370-L	139.95
67-73 RH (pictured).....	760-1370-R	139.95

Will fit 74-76 with slight modification

770) Outer Wheelhouse

Use when replacing quarter panel



Barracuda

67-69 LH.....	770-1267-L	129.95
67-69 RH.....	770-1267-R	129.95

Dart

67-76 LH.....	770-1067-L	129.95
67-76 RH.....	770-1067-R	129.95
73-76 Dart Sport, LH.....	770-1370-L	129.95
73-76 Dart Sport, RH (pictured).....	770-1370-R	129.95

Duster / Demon

70-76 LH.....	770-1267-L	129.95
70-76 RH.....	770-1267-R	129.95

795) Quarter Glass, see page 43

800) Trunk Floor, OE Style



67-76.....	800-1370	299.95
------------	----------	--------

810) Trunk Lock Support

Use when replacing trunk floor or taillight panel

Dart

67-69.....	810-1067	79.95
70-73.....	810-1070	79.95
1973 Sport.....	810-1370	79.95

Duster / Demon

70-73 (pictured).....	810-1370	79.95
-----------------------	----------	-------



825) Trunk Gutter

Use when replacing quarter panel

Dart

67-69 3-piece set, LH (lower fits 1970).....	825-2067-L	109.95
67-69 3-piece set, RH (lower fits 1970).....	825-2067-R	109.95
67-69 6-piece set (lower fits 1970).....	825-2067-S	199.95
70-72 LH.....	825-2070-L	109.95
70-72 RH.....	825-2070-R	109.95
70-72 Pair.....	825-2070-S	199.95
73-76 Sport, LH.....	825-1370-L	79.95
73-76 Sport, RH.....	825-1370-R	79.95
73-76 Sport, Pair.....	825-1370-S	149.95

Duster / Demon

70-76 LH.....	825-1370-L	79.95
70-76 RH.....	825-1370-R	79.95
70-76 Pair (pictured).....	825-1370-S	149.95



840) Trunk Floor Extension

Use when replacing quarter panel



Dart

67-69 LH (pictured, left)	840-1067-L	99.95
67-69 RH (pictured, right)	840-1067-R	99.95
70-72 LH	840-1070-L	99.95
70-72 RH	840-1070-R	99.95

70-72 will fit 73-76 with minor modifications

73-76 Dart Sport	840-1370-L	99.95
73-76 Dart Sport	840-1370-R	99.95

Duster / Demon

70-76	840-1370-L	99.95
70-76	840-1370-R	99.95

841) Trunk Floor Extension End Cap

Use when replacing quarter panel

Dart

73-76 Dart Sport, LH	841-1370-L	34.95
73-76 Dart Sport, RH	841-1370-R	34.95

Duster / Demon

70-76 LH	841-1370-L	34.95
70-76 RH	841-1370-R	34.95



842) Trunk Floor Extension Brace

Use when replacing trunk floor extension

Duster/Demon/Dart Sport

70-76 LH=RH	842-1370	16.95
-------------	----------	-------



860) Upper Rear Crossmember (Shock Mount)

67-76	860-1067	179.95
-------	----------	--------



865) Rear Leaf Spring Mount

67-76 LH, Rear	865-1067-2L	39.95
67-76 RH, Rear	865-1067-2R	39.95



870) Rear Crossmember

67-76	870-1067	199.95
-------	----------	--------



871) Rear Crossmember Extension

67-76 Pair	871-1067-P	39.95
------------	------------	-------



Can't find your part in our catalog? Many new "A"-Body items are being developed! Call Us!

890) Gas Tank

We now have a complete line of Spectra Premium Industries brand gas tanks. These tanks are the best on the market and have an OE appearance. All popular models in stock at competitive prices.



1963 (with grommet)	890-1063	229.95
64-66 (small 2" filler hole) (pictured)	890-1064	229.95
68-70 (without vent pipe)	890-1068	229.95
70-71 (4 side vent pipes)	890-1070-4	229.95
71-76 (1 front vent pipes)	890-1071	229.95

895) Rear Frame Rail, OE Style



67-76 LH	895-1067-L	INQUIRE
67-76 RH	895-1067-R	INQUIRE

900) Taillight Panel

Demon



71-72	900-2371	299.95
-------	----------	--------

Duster



70-71	900-1370	299.95
-------	----------	--------



1972	900-1372	299.95
------	----------	--------



1973 (modify for 74-76)	900-1373	299.95
-------------------------	----------	--------

910) Taillight Brackets

Use when replacing taillight panel

Demon

71-72 LH (pictured)	910-1370-L	79.95
71-72 RH	910-1370-R	79.95



Duster

70-71 LH	910-1370-L	79.95
70-71 RH	910-1370-R	79.95
1972 LH (pictured)	910-1372-L	79.95
1972 RH	910-1372-R	79.95



920) Taillight Panel Reinforcement Brackets

Use when replacing trunk floor

Dart

67-72 Pair	920-1067-P	59.95
------------	------------	-------

Duster / Demon / Dart Sport

70-76 Pair (pictured)	920-1370-P	59.95
-----------------------	------------	-------



MOPAR, JEEP, DODGE, HEMI, PLYMOUTH, and CHRYSLER are trademarks of Chrysler LLC used under license to Auto Metal Direct, LLC. © Chrysler LLC 2008

940 Sherwin Parkway, Suite 180
Buford, GA 30518

(866) 591-8309

960) Rear Valance
(Welds in place like OE)



Barracuda



67-69 without tips 960-1267 229.95



68-69 with tips, can also fit 1967 960-1267-T 229.95

Dart



70-72 960-2070 229.95

970) Rear Bumper Bracket Set
Barracuda



67-69 2 pieces 970-1267-S 99.95



67-69 Front/Rear/Outer Set, 10 pieces .. 105-1267-1S 239.95

Dart



67-69 2 pieces 970-2067-S 89.95
67-69 Front/Rear Set, 6 pieces 105-2067-1S 189.95

Duster



70-72 4 pieces 970-1370-S 89.95
70-72 Front/Rear Set, 8 pieces 105-1370-1S 189.95

106) Stabilizer Bracket

(between bumper and quarter panel)

67-69 Barracuda, Pair
(also fits front).... 106-1267-S 19.95



990) Rear Bumper & Bumperettes
Barracuda



67-69 (also fits front)..... 100-1267 309.95
67-69 Front/Rear Set..... 100-1267-S 609.95

Dart

68-69 990-2068 *INQUIRE*
70-71 without jack slots 990-2070 279.95
Can fit 1972 but requires 1970-71 style jack

Duster / Demon



70-71 without jack slots 990-1370 309.95
70-71 without jack slots, Front/Rear Set... 100-1370-S 609.95
71-72 with jack slots 990-1371 309.95
71-72 with jack slots, Front/Rear Set..... 100-1371-S 609.95

GLASS

Now you can finally get **quality** reproduction glass for your A-Body Dodge or Plymouth muscle car! For years restorers have been stuck with inaccurate reproduction glass. It was too thin, didn't fit, and lacked the authentic Mopar Pentastar logo. Here at Auto Metal Direct we know that details really do matter, so we are proud to offer the following glass selection, complete with Mopar logo, and *licensed by Chrysler!*
(Not date coded)

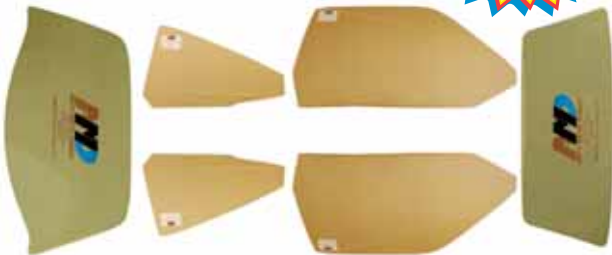

499) Complete Glass Kits

Dart Sport

73-74 Clear 499-1373-CS 999.95
73-74 Tinted 499-1373-TS 999.95
74-76 Clear (7 hole) 499-1374-CS 999.95
74-76 Tinted (7 hole) 499-1374-TS 999.95

Dart

67-72 Clear 499-2067-CS 999.95
67-72 Tinted 499-2067-CT 999.95

Demon

71-72 Clear 499-1370-CS 999.95
71-72 Tinted 499-1370-TS 999.95

Duster

70-72 Clear 499-1370-CS 999.95
70-72 Tinted 499-1370-TS 999.95
73-74 Clear 499-1373-CS 999.95
73-74 Tinted 499-1373-TS 999.95
74-76 Clear (7 hole) 499-1374-CS 999.95
74-76 Tinted (7 hole) 499-1374-TS 999.95

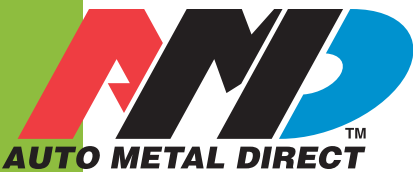

Our Name Says It All!™

www.autometaldirect.com

380) Windshield

Barracuda

67-69 Clear	380-1067-C	199.95
67-69 Tinted	380-1067-T	199.95

Dart

67-76 Clear	380-1067-C	199.95
67-76 Tinted	380-1067-T	199.95
70-76 Dart Sport, Clear	380-1370-C	199.95
70-76 Dart Sport, Tinted	380-1370-T	199.95

Duster / Demon

70-76 Clear	380-1370-C	199.95
70-76 Tinted	380-1370-T	199.95

550) Door Glass

Dart

67-72 LH, Clear	550-2067-CL	149.95
67-72 RH, Clear	550-2067-CR	149.95
67-72 LH, Tinted	550-2067-TL	149.95
67-72 RH, Tinted	550-2067-TR	149.95

Dart Sport

73-74 LH, Clear (5 hole)	550-1373-CL	179.95
73-74 RH, Clear (5 hole)	550-1373-CR	179.95
73-74 LH, Tinted (5 hole)	550-1373-TL	179.95
73-74 RH, Tinted (5 hole)	550-1373-TR	179.95
74-76 LH, Clear (7 hole)	550-1374-CL	179.95
74-76 RH, Clear (7 hole)	550-1374-CR	179.95
74-76 LH, Tinted (7 hole)	550-1374-TL	179.95
74-76 RH, Tinted (7 hole)	550-1374-TR	179.95

Demon

70-72 LH, Clear (6 hole)	550-1370-CL	179.95
70-72 RH, Clear (6 hole)	550-1370-CR	179.95
70-72 LH, Tinted (6 hole)	550-1370-TL	179.95
70-72 RH, Tinted (6 hole)	550-1370-TR	179.95

Duster

70-72 LH, Clear (6 hole)	550-1370-CL	179.95
70-72 RH, Clear (6 hole)	550-1370-CR	179.95
70-72 LH, Tinted (6 hole)	550-1370-TL	179.95
70-72 RH, Tinted (6 hole)	550-1370-TR	179.95
73-74 LH, Clear (5 hole)	550-1373-CL	179.95
73-74 RH, Clear (5 hole)	550-1373-CR	179.95
73-74 LH, Tinted (5 hole)	550-1373-TL	179.95
73-74 RH, Tinted (5 hole)	550-1373-TR	179.95
74-76 LH, Clear (7 hole)	550-1374-CL	179.95
74-76 RH, Clear (7 hole)	550-1374-CR	179.95
74-76 LH, Tinted (7 hole)	550-1374-TL	179.95
74-76 RH, Tinted (7 hole)	550-1374-TR	179.95

560) Vent Glass

Dart

67-72 LH, Clear	560-2067-CL	79.95
67-72 RH, Clear	560-2067-CR	79.95
67-72 LH, Tinted	560-2067-TL	79.95
67-72 RH, Tinted	560-2067-TR	79.95

660) Back Glass

Dart

67-72 Clear	660-2067-C	249.95
67-72 Tinted	660-2067-T	249.95

Dart Sport / Duster / Demon

70-76 Clear	660-1370-C	249.95
70-76 Tinted	660-1370-T	249.95

795) Quarter Glass

Dart

67-72 LH, Clear	795-2067-CL	139.95
67-72 RH, Clear	795-2067-CR	139.95
67-72 LH, Tinted	795-2067-TL	139.95
67-72 RH, Tinted	795-2067-TR	139.95

Dart Sport

73-76 LH, Clear	795-1373-CL	139.95
73-76 RH, Clear	795-1373-CR	139.95
73-76 LH, Tinted	795-1373-TL	139.95
73-76 RH, Tinted	795-1373-TR	139.95

Demon

70-72 LH, Clear	795-1370-CL	139.95
70-72 RH, Clear	795-1370-CR	139.95
70-72 LH, Tinted	795-1370-TL	139.95
70-72 RH, Tinted	795-1370-TR	139.95

Duster

70-72 LH, Clear	795-1370-CL	139.95
70-72 RH, Clear	795-1370-CR	139.95
70-72 LH, Tinted	795-1370-TL	139.95
70-72 RH, Tinted	795-1370-TR	139.95
73-76 LH, Clear	795-1373-CL	139.95
73-76 RH, Clear	795-1373-CR	139.95
73-76 LH, Tinted	795-1373-TL	139.95
73-76 RH, Tinted	795-1373-TR	139.95



796) Quarter Glass Latch Assembly

70-76 Duster, Pair	796-1468-P	139.95
71-72 Demon, Pair	796-1468-P	139.95

Now, get great-fitting glass for your Mopar muscle car, with this premium quality reproduction glass from the Mopar restoration professionals at Auto Metal Direct! Licensed by Chrysler, this glass includes the authentic Pentastar logo.

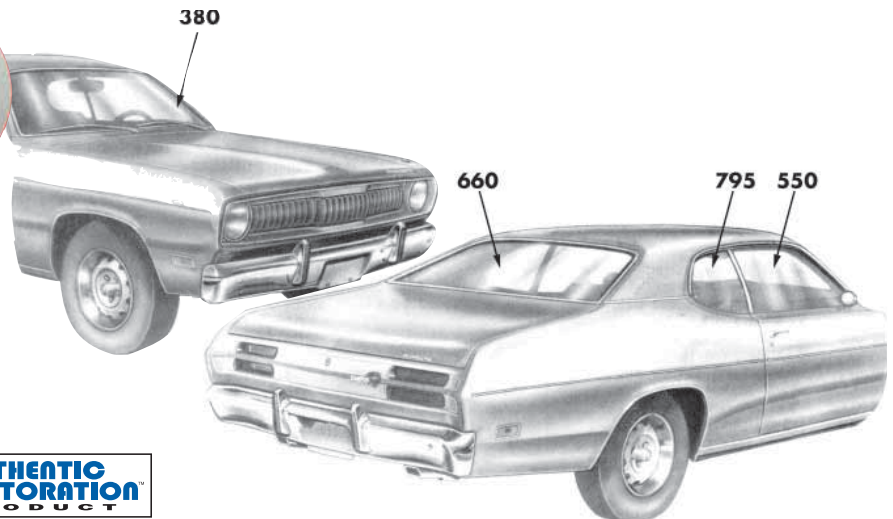

940 Sherwin Parkway, Suite 180
Buford, GA 30518

(866) 591-8309

Our huge new warehouse is jammed full of beautiful new sheet metal panels for Dodge and Plymouth muscle cars. If you live in the southeastern US, why not come on by and pick up your body panels in person? Save those shipping dollars to buy parts you'll need to finish your car!



Now Available!

Sheet Metal Installation Videos

Shot in HD, these DVDs combine the clear vision of the helmet cam and the easy teaching style of nationally recognized car builder, Craig Hopkins. No matter what your skill level, these DVDs will help you get professional results!

MIG Welding Automotive Sheetmetal

MIG welding automotive sheet metal has just become a lot less frustrating. You quickly learn professional techniques because you see and hear about methods that will improve your welding.

MIG Welding Automotive Sheetmetal video..... VIDEO1 19.95



Center Trunk Floor Replacement

Almost 2 hours of valuable information that will stop you from making costly errors and leave you with hard-to-spot repairs.

Center Trunk Floor Replacement video VIDEO2 19.95



Patch Panel Installation

Almost 2 hours of methods and tips that will give you professional results with your "do-it-yourself" project.

Patch Panel Installation video..... VIDEO3 19.95



videos by howtoASAP.com

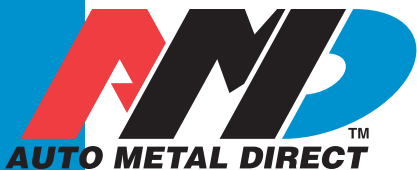

Our Name Says It All!™ www.autometaldirect.com



Ordering

First, double-check your order before contacting us. Make sure you didn't miss that extra tail light bracket or support that you needed, and then give us a call. Ordering everything at once can save you a lot on shipping. Call us to place your order toll free at (866) 591-8309, mail in your order form, fax your order to (770) 692-6360, or email us at sales@autometaldirect.com.

Mail in orders should be sent to:

940 Sherwin Parkway, Suite 180
Buford, GA 30518

Prices

Due to unforeseeable price increases associated with manufacturing, all prices are subject to change without prior notification. Call to ensure up-to-date pricing and to check product availability. The pricing in this catalog supersedes any previous publication.

Payment

We accept MasterCard, Visa, American Express, and Discover. We also accept payment via money order, cashiers check, or personal check. **AM** reserves the right to hold orders paying by personal check for 3-5 days to allow for clearance. Sorry, we cannot ship any orders COD.

Shipping

We ship small parcels via FedEx Ground. FedEx Next-Day Air and 2nd Day Air also available. Please ask your sales representative if you would like a faster service than ground. **AM** will charge you actual shipping rates established by FedEx Ground. We do not have a standardized shipping schedule based on order size. We are able to send FedEx orders into Canada.

Orders too large to ship by FedEx (Hoods, Fenders, Full Floors, etc.) will be shipped via Truck Freight. The truck freight carrier will be determined at the time of shipping. We can ship your order to your house, but truck freight fees for orders sent to a business located in a zoned commercial area are substantially lower. As with FedEx, we do not have a standardized shipping schedule based on size or location. Please call us for a shipping quote prior to ordering.

Damages

You must inspect all truck freight shipments for damage at the time of delivery! If your shipment contains damage, please mark 'Damaged' on the freight bill and call us immediately at 866-591-8309. You **MUST** sign the freight bill as damaged in order for us to help you file a claim with the truck carrier! If you sign the freight bill free of damage, **AM** and the delivering truck company are not responsible for damages.

Additional Boxing Fees

Due to the fragile nature of glass, we have gone the extra mile in packaging orders that contain glass kits and individual pieces. The following charges will be added to glass orders. This fee is to cover the cost of the protective packaging and will be added to the actual shipping fee.

- Windshield/Back Glass Add \$30.00
- Complete Glass Kit Add \$50.00

Returns

You may return any unused, undamaged, and resalable part in its original packaging for exchange credit or refund up to 6 months after purchase. Orders approved after 6 months are subject to a 10% restocking fee. **All returns must have prior approval before returning them to us.** Shipping fees that are incurred from returning any part to us is your responsibility. Finally, if the return shipment is damaged in transit, you are responsible for filing the claim with the carrier.

All **AM items are made on our own steel tools.**

Parts Guarantee

All **AM** products are guaranteed to be free from defects in material and workmanship. Test fit all parts before sanding, priming, or painting them. If we deem your part defective, our responsibility is to replace the part, issue credit, or refund the original purchase price. We are not responsible for any paint or labor expenses. The credit or refund amount will not exceed the defective parts original purchase price.

Backorders

Any items not available at the time the order is placed will be put on backorder. All backordered parts that ship after the original shipment will be subject to additional shipping fees. Backorders will not be shipped without your prior authorization. Please let us know if you do not wish to receive backorders.

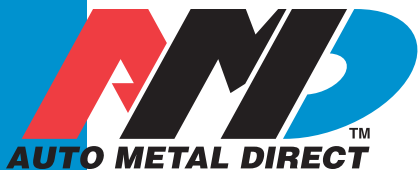

THE DETAILS MAKE OUR PARTS SUPERIOR!

Don't settle for incorrect, *lightweight* cheapo parts for your MOPAR muscle car. Get premium sheet metal parts for your Dodge or Plymouth, from Auto Metal Direct (AMD). Our panels include all correct-as-original clips, tabs, flanges, bends, and seams. We often wonder how other manufacturers expect you to replace those original tabs and clips which were rusted off on your original. It would be nearly impossible to do so correctly, especially on lighter-weight-than-original steel panels!



Call AMD today, or visit our website for full details.

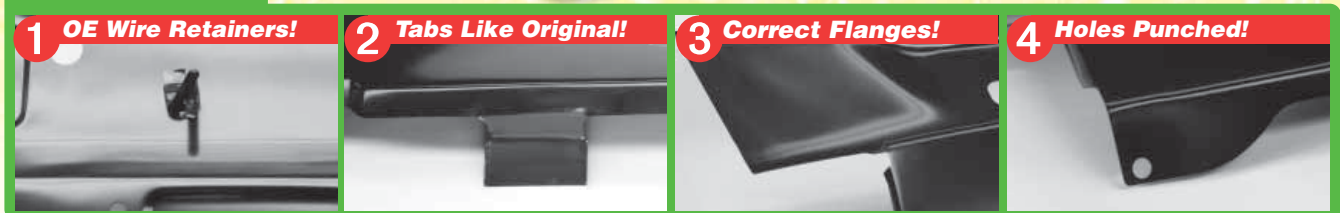

Cheapo Parts

COMPARE QUALITY BEFORE YOU BUY!

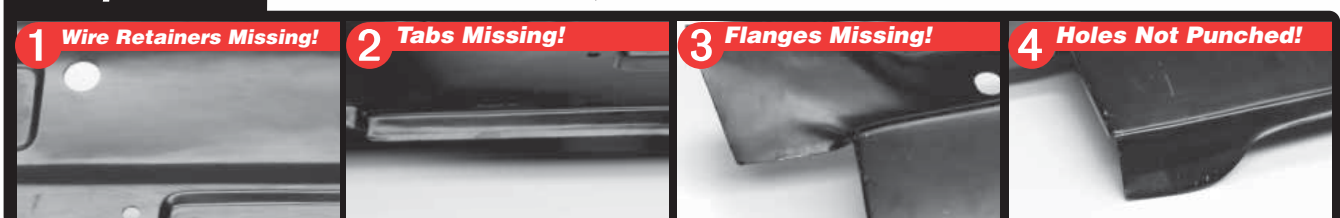

940 Sherwin Parkway • Suite 180 • Buford, GA 30518
(866) 591-8309
www.autometaldirect.com

PLYMOUTH & DODGE BODY PANELS

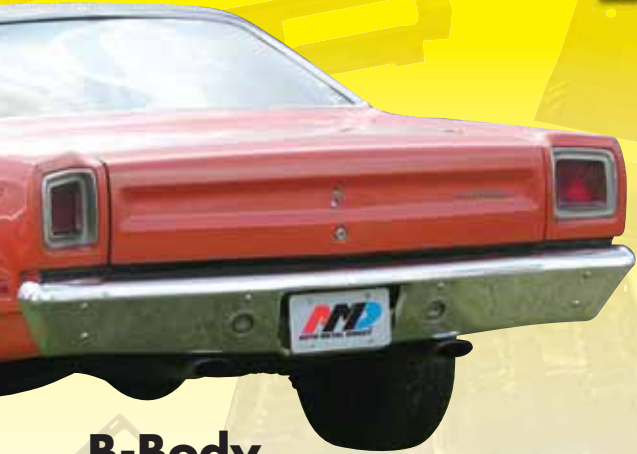

B-Body



E-Body



A-Body



Auto Metal Direct

940 Sherwin Parkway, Suite 180 • Buford, GA 30518

Call
Toll Free: **(866) 591-8309**
www.autometaldirect.com

